



### Warning!

Flat glass units are heavy.  
Large units may require a mechanical lift

For Standard Flat Glass  
Rooflight on to 150mm or  
300mm Kerb  
See Page 2 overleaf

## Contents

**i** Please unpack and check that all correct parts are included and undamaged.

All Standard Flat Glass Rooflights

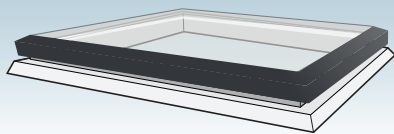

### Fixing Quantities

Length of Nominal rooflight Side (mm)	Number of fixings per side
600, 750	2
900, 1050, 1200	3
1350, 1500, 1650	4
1800, 1950	5
2100, 2250	6
2400	7

(All fixings supplied in packs of 5.)

With either assembly, you will receive:

#### Kerb Fixings

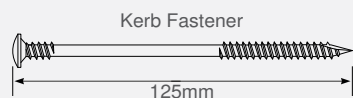

#### Manual Opening Unit Extras

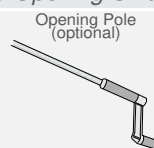

## Opening Unit - Pre-Installation Information

Please note that all Health and Safety Regulations must be followed on site throughout the installation process.

## Installation Instructions

### Manual Opening rooflight on existing upstand

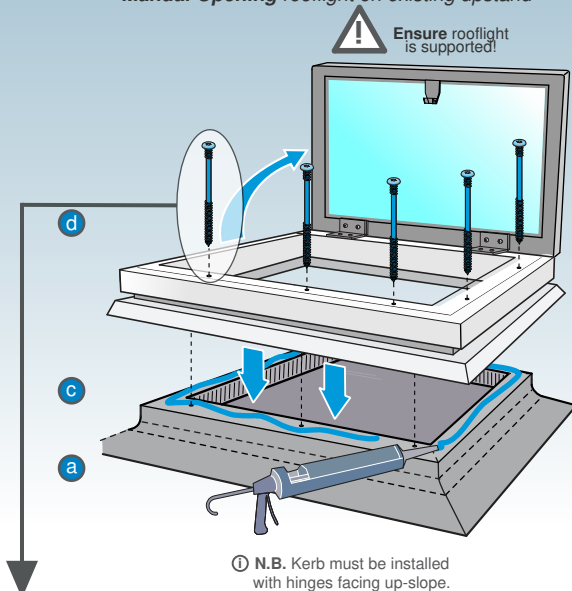

**!** Ensure rooflight is supported in open position to avoid damage!

**a** Install roof covering to cover existing upstand in accordance with manufacturer's installation recommendations.

**!** **N.B.** It is important that there should be no excessive build up of layers, the top surface should be level and free from any protrusions or projections which may prevent adequate weather proofing.

**b** Carefully remove roof light from its packaging and ensure that hinged rooflight is unlocked from frame and can be opened to 90°. If not disconnect, as shown.

**c** Mastic/Silicone around the edge of the upstand opening and correctly place kerb, ensuring it is located squarely to the upstand with hinges facing up-slope.

**d** Fix kerb to the builders upstand using the 125mm kerb fastener.

**e** Ensure that the hinged rooflight is connected to the frame and locked into the closed position

### Kerb Fixing

### Installation

**!** Please note that all Health and Safety Regulations must be followed on site throughout the installation process.

**d** All Standard Flat Glass Rooflights

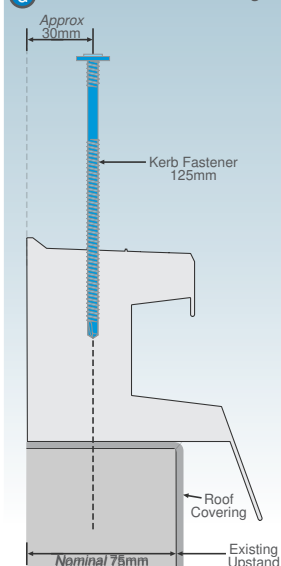

**b e** Rooflight connection to frame

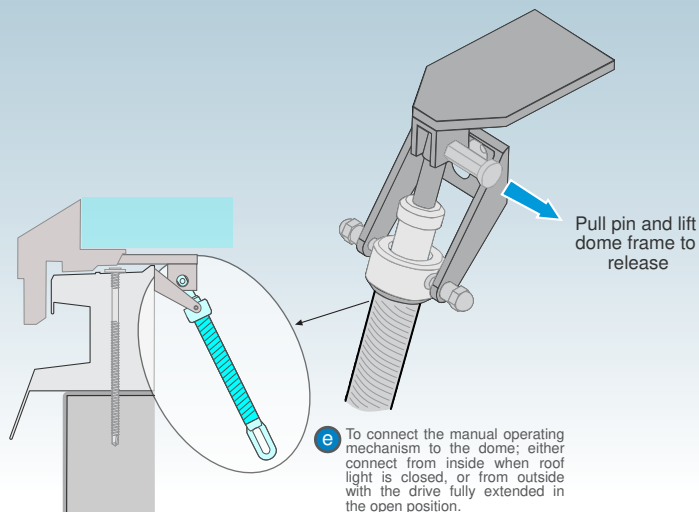

**e** To connect the manual operating mechanism to the dome; either connect from inside when roof light is closed, or from outside with the drive fully extended in the open position.

**!** **TECHNICAL SUPPORT:** For any technical information/queries please contact your supplier.

The manufacturer operates a policy of continuous product improvement, and reserves the right to alter specifications at any time without notice. Every effort has been taken to ensure all details contained in this document are correct at the time of going to press but this document should be used only as a guide and does not in any way form part of a contract or warranty. It is the customer's responsibility to ensure that the product is suitable for the actual conditions of use, which are beyond the control of the manufacturer.



### Warning!

Flat glass units are heavy.  
Large units may require a mechanical lift

## Contents

**i** Please unpack and check that all correct parts are included and undamaged.

All Standard Flat Glass Rooflights

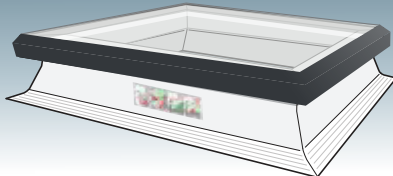

For Standard Flat Glass Rooflight on to Existing Upstand  
See Page 1 overleaf

### Fixing Quantities

Length of Nominal rooflight Side (mm)	Number of fixings per side
600, 750	2
900, 1050, 1200	3
1350, 1500, 1650	4
1800, 1950	5
2100, 2250	6
2400	7

(All fixings supplied in packs of 5).

With either assembly, you will receive:

### Kerb Fixings

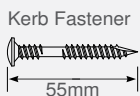

### Manual Opening Unit Extras



## Installation

**⚠** Please note that all Health and Safety Regulations must be followed on site throughout the installation process.

### Installation Instructions

### Manual Opening rooflight on to 150mm or 300mm kerb

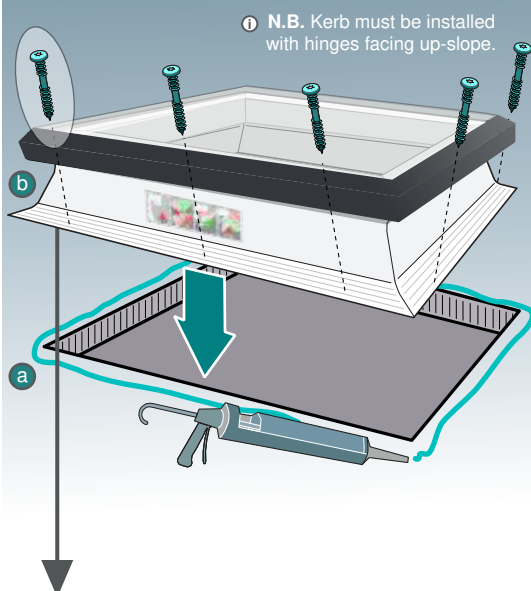

**i** N.B. Kerb must be installed with hinges facing up-slope.

### c Roof Covering Installation

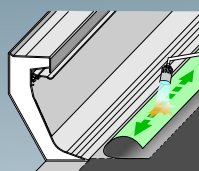

If required, lightly torch roof covering.



**WARNING:**  
Never apply direct heat or naked flame to the roof light!

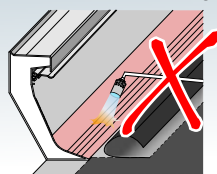

### d

**IMPORTANT:**  
You Will Receive Either

Type A 'CLAMP'



OR  
Type B 'COVER TRIM'



**a** Mastic/Silicone around the edge of the roof opening and correctly position kerb, ensuring it is located squarely over the roof opening with hinges facing up-slope.

**b** Fix kerb to the roof using the 55mm kerb fastener.

See above **Fixing Quantities** table for the correct quantity of fastenings required for the size of the rooflight.

**i** N.B. Length of side refers to the nominal rooflight size (equivalent to inside base of kerb foot).

**c** Remove and retain kerb label then install roof covering up to lip, ensuring it **does not** foul clamp or cover trim. Install in accordance with manufacturer's installation recommendations

**d** Lock the roof covering clamp or cover trim down fully, following instructions on kerb label

**e** See e (below) for further information on opening mechanism

### Kerb Fixing

### Opening Unit - Further Information

### c d All Standard Flat Glass Rooflights

- Kerb
- Roof Covering
- Structural Member
- Insulation

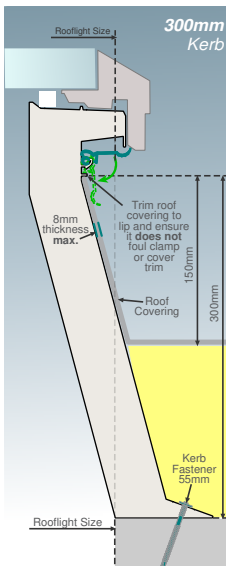
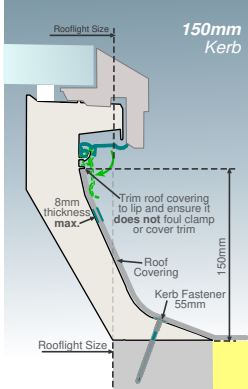

### e For Manual Linear Drive Connection

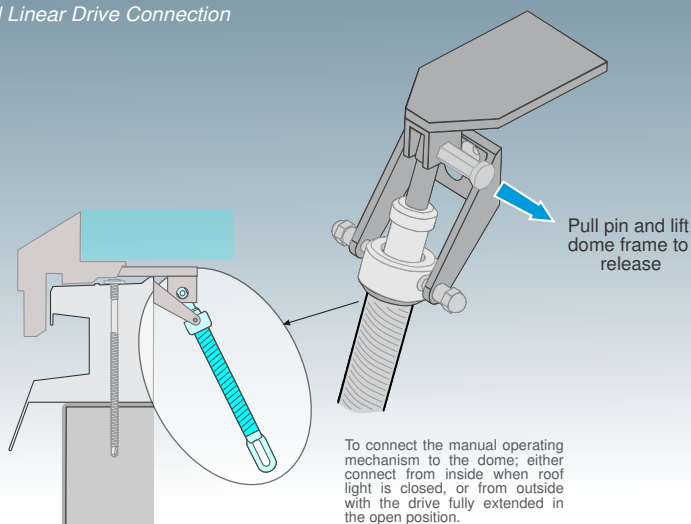

Pull pin and lift dome frame to release

To connect the manual operating mechanism to the dome: either connect from inside when roof light is closed, or from outside with the drive fully extended in the open position.

**ⓘ TECHNICAL SUPPORT:** For any technical information/queries please contact your supplier.

The manufacturer operates a policy of continuous product improvement, and reserves the right to alter specifications at any time without notice. Every effort has been taken to ensure all details contained in this document are correct at the time of going to press but this document should be used only as a guide and does not in any way form part of a contract or warranty. It is the customer's responsibility to ensure that the product is suitable for the actual conditions of use, which are beyond the control of the manufacturer.