

Bi-Folding Door

Installation Guide

Section A

Door Installation A1 - A7

Section B

Lock Adjustment B1



Section C

Kit-Form Pre-Assembly C1 - C2

Section D

De-Glazing Instruction D1



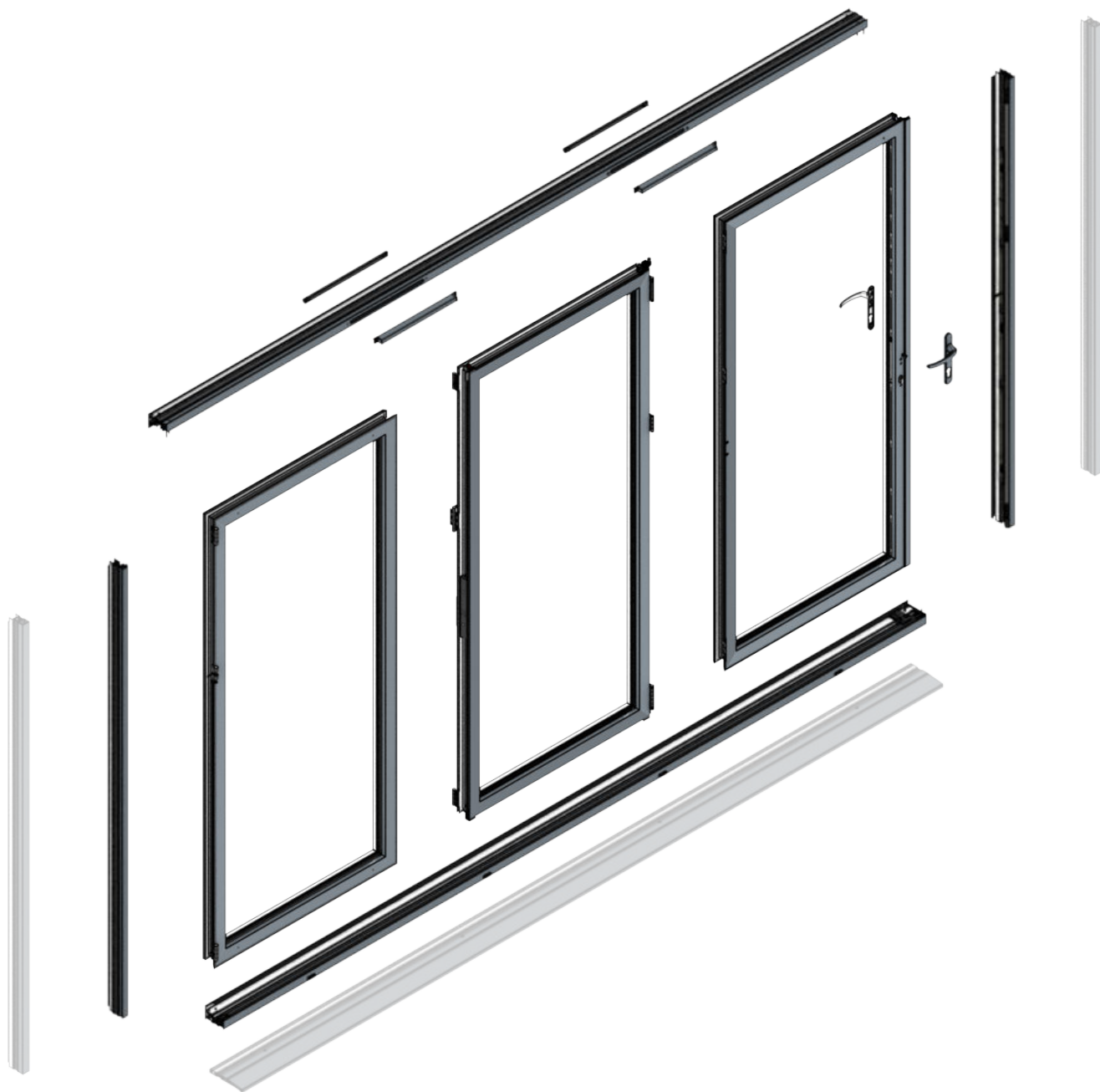

TOOLS REQUIRED



Tape measure

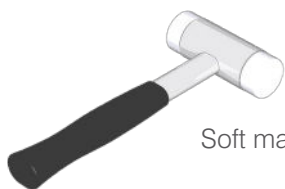

Soft mallet



Spirit level



4mm hex key



Glazing paddle

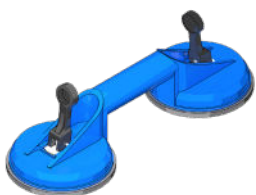

Glazing suction lifters



Cordless
drill / driver



Pozi No 2
Bit



3 & 5mm
Drill Bits

PACKAGING CONTENTS

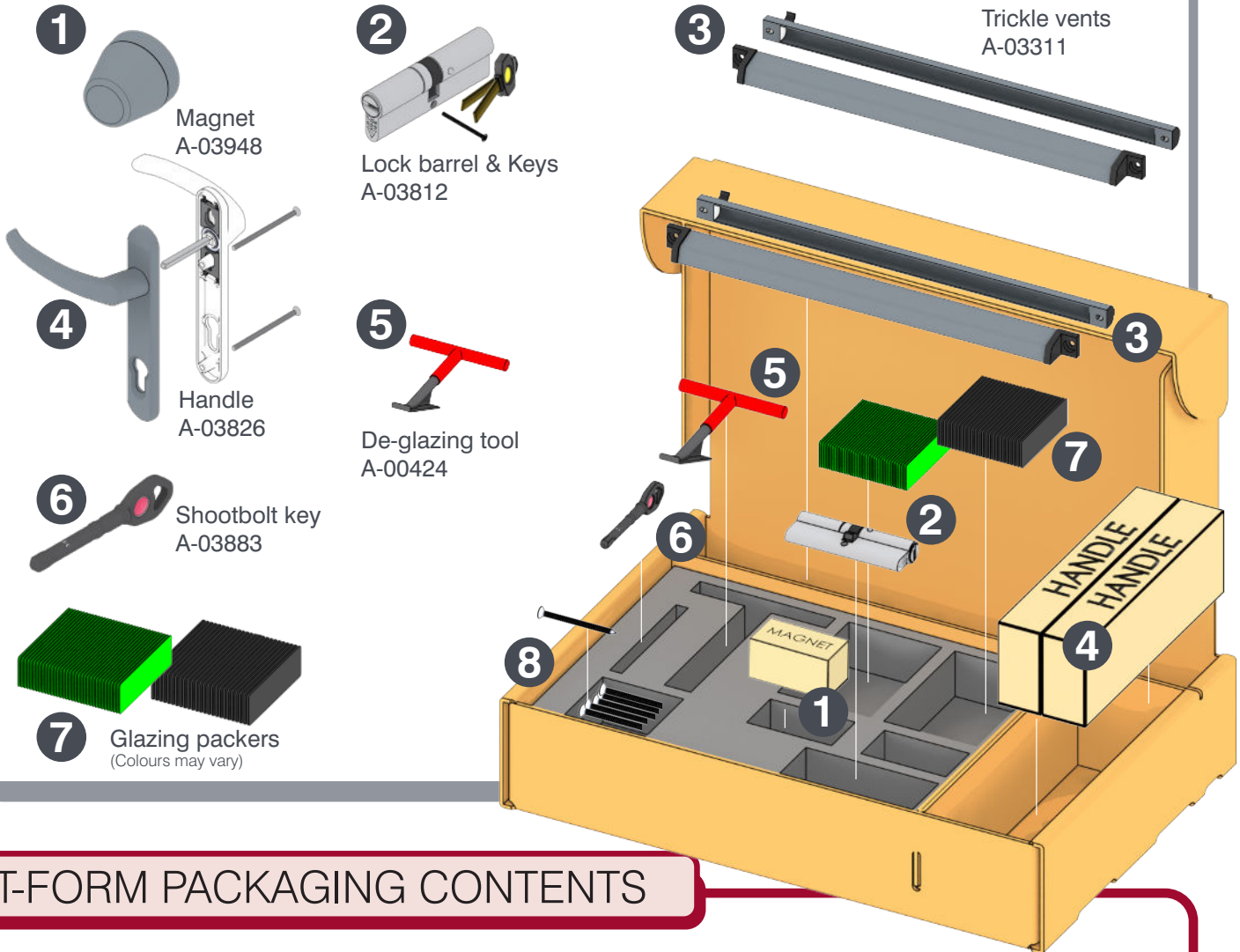

KIT-FORM PACKAGING CONTENTS



CONSUMABLES - NOT SUPPLIED



BEAD UNPACKING

A1

1 Bead and bead spacer removal before installation

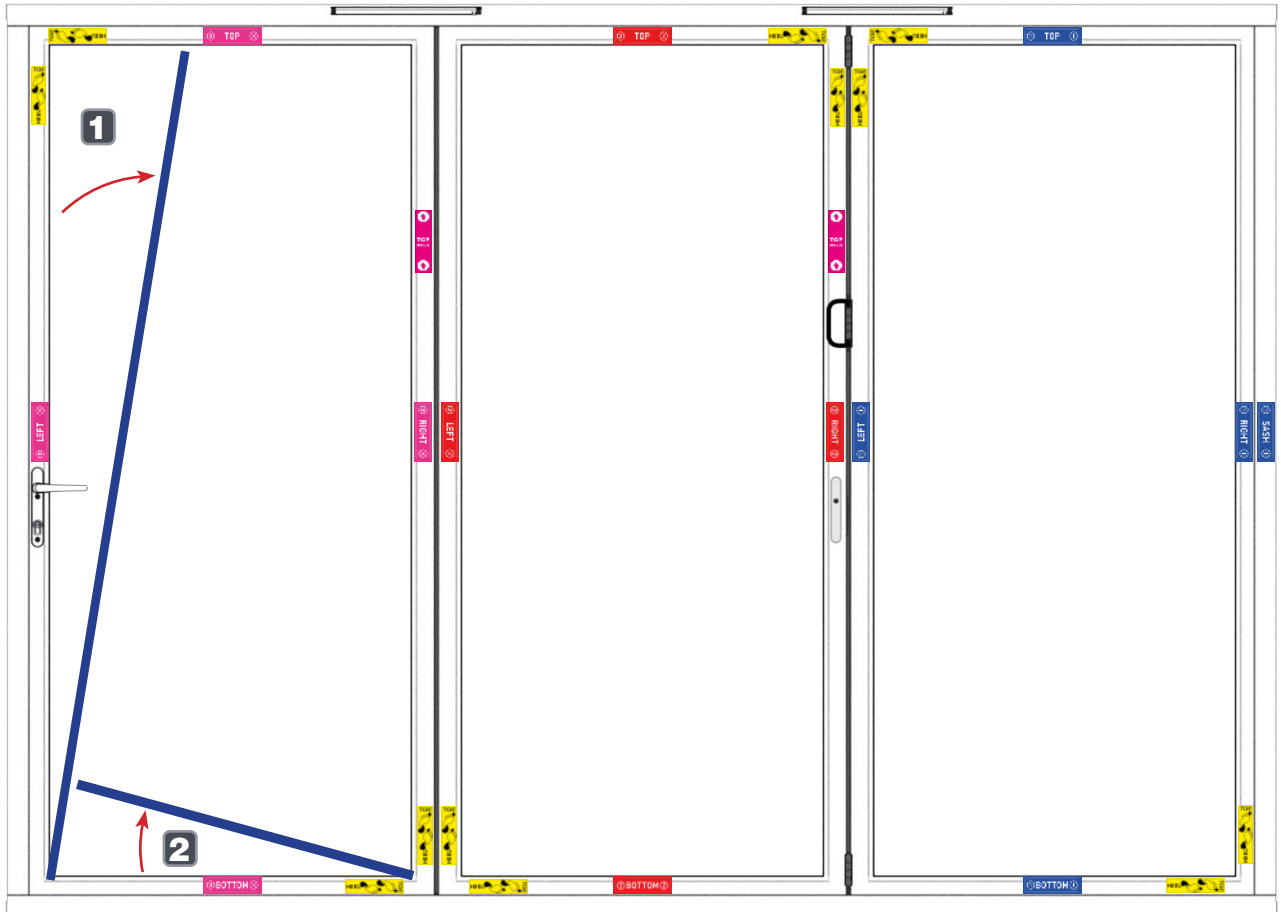

Beads must return to original positions

Polystyrene bead spacer removal

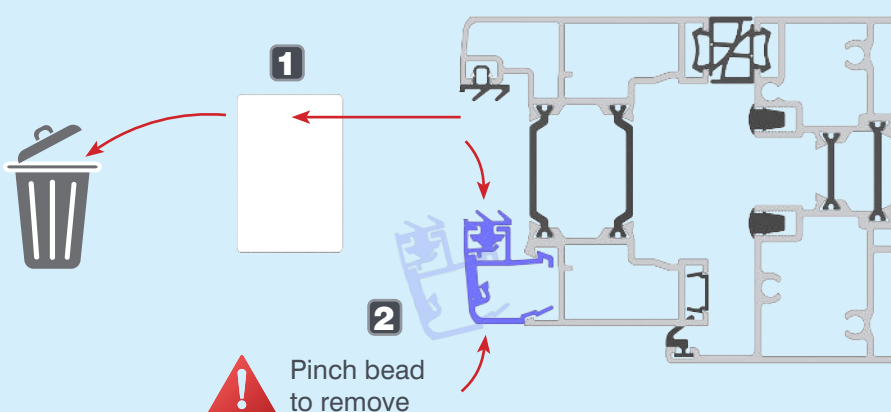

GENERAL ASSEMBLY

HANDLE INSTALLATION

A2



1 Handle assembly

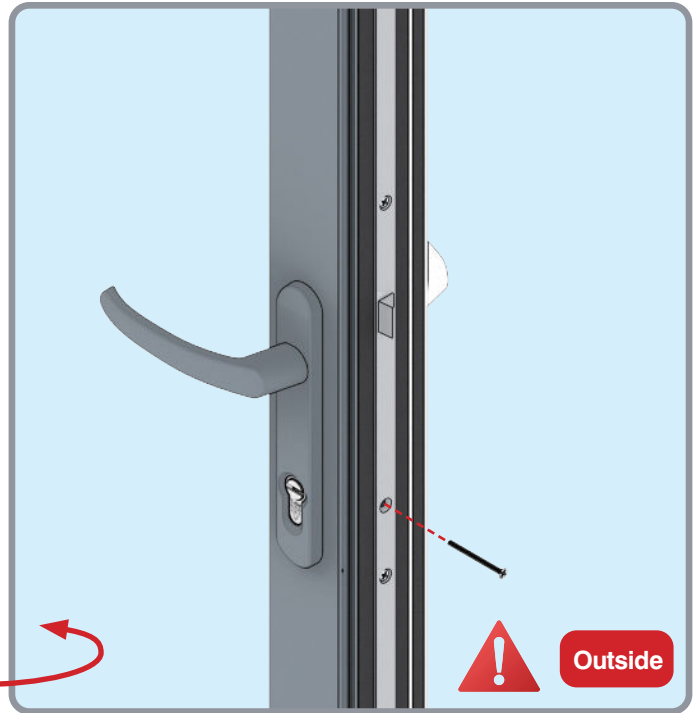
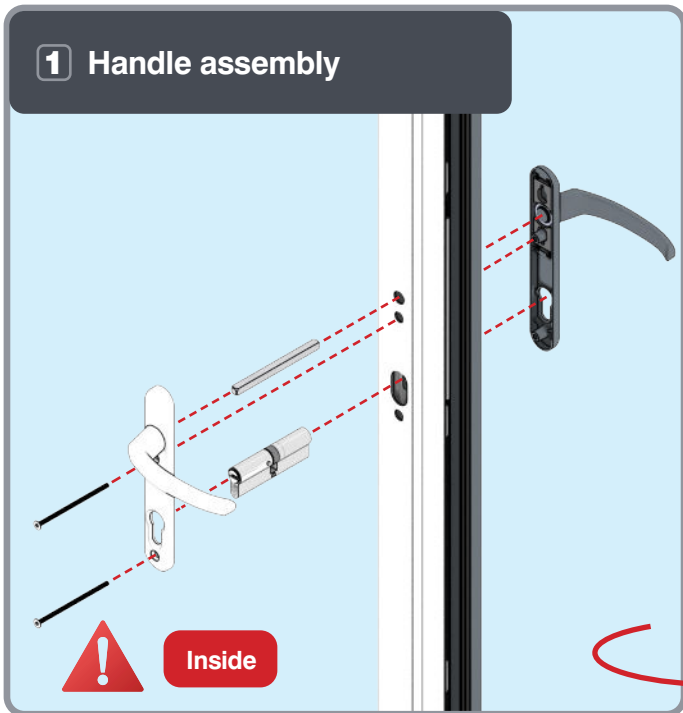

OPTIONAL TRICKLE VENT INSTALLATION

1 Trickle vent assembly

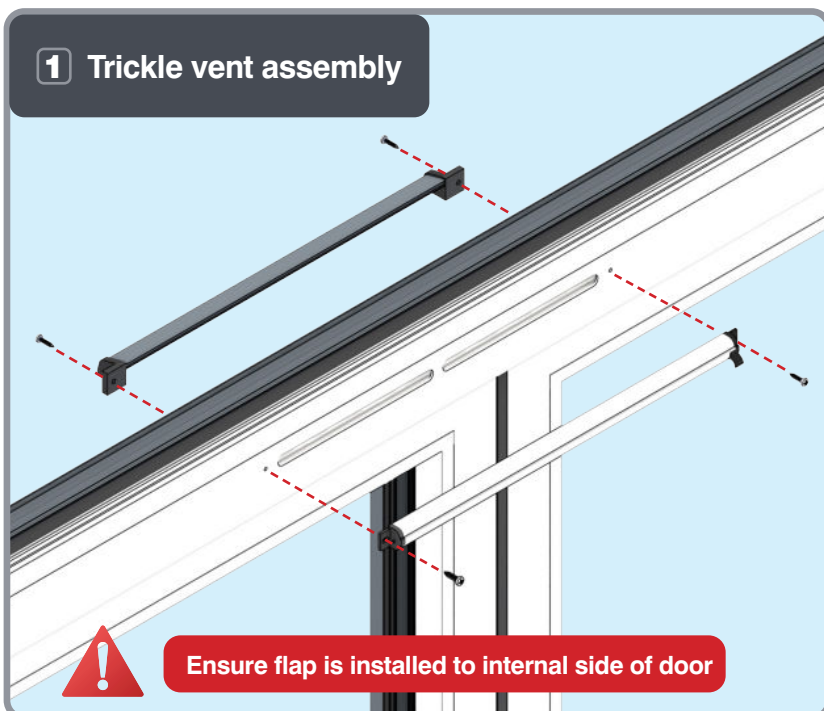

2

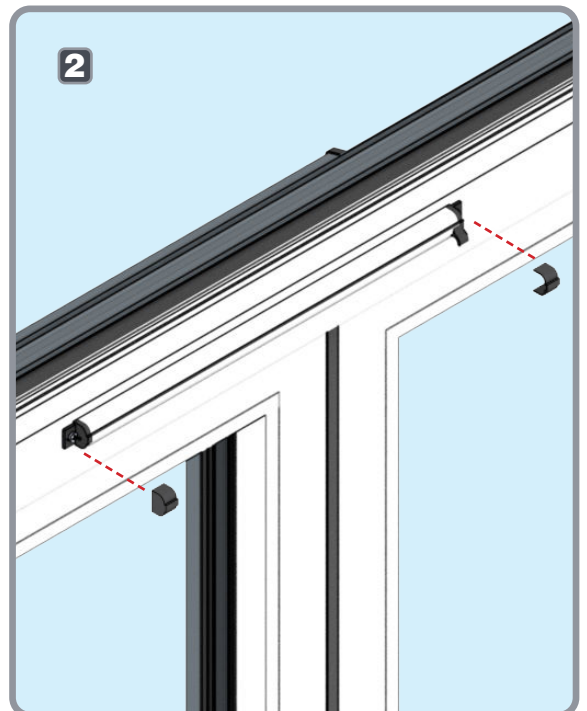

CILL INSTALLATION

A3



Outer frame packers
(not supplied)

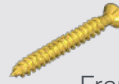

Frame fixing screws
(not supplied)



Low modulus silicone sealant
(not supplied)

1 Drilling

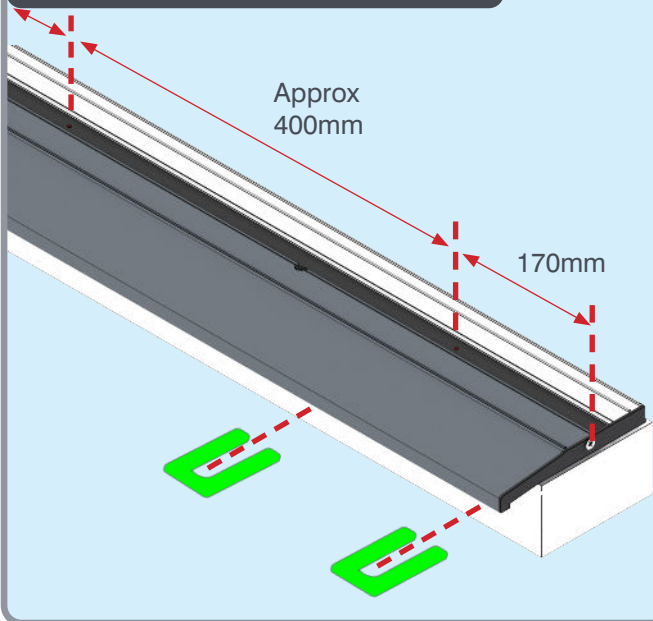

2 Leveling and fixing cill

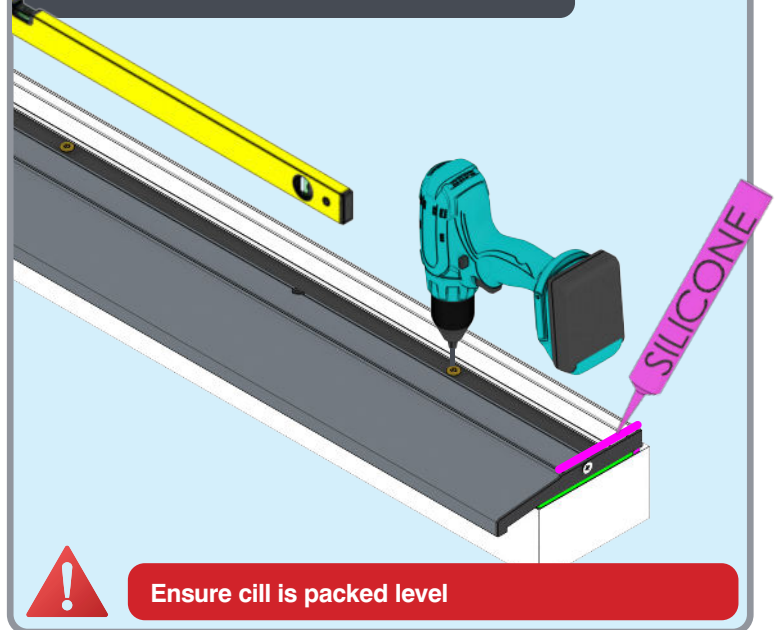

Ensure cill is packed level

3 Completed cill position showing packer

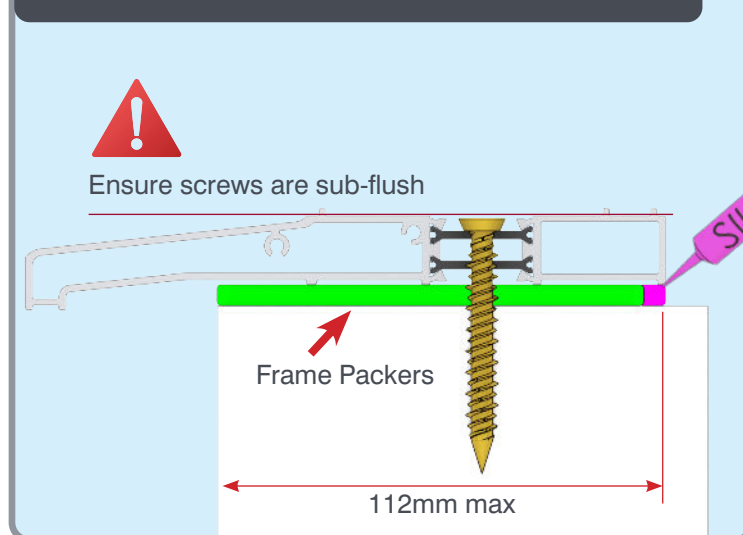

Note - Cill packers and screws are not supplied

Ensure cill is level: ± 1 mm



DOOR POSITIONING

A4



Only remove keep when keep mounted to outerframe

1 Keep removal when on jamb

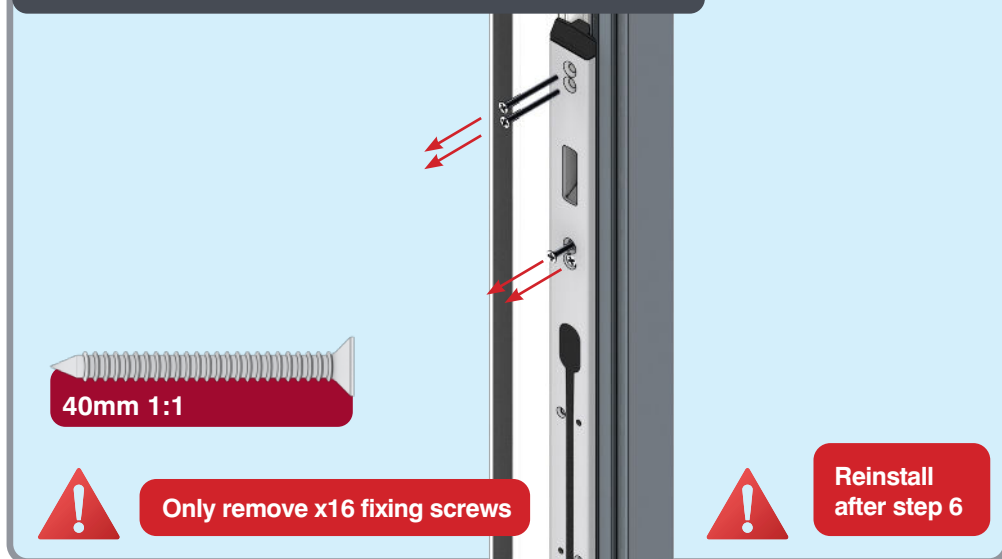

2 Vertical Alignment

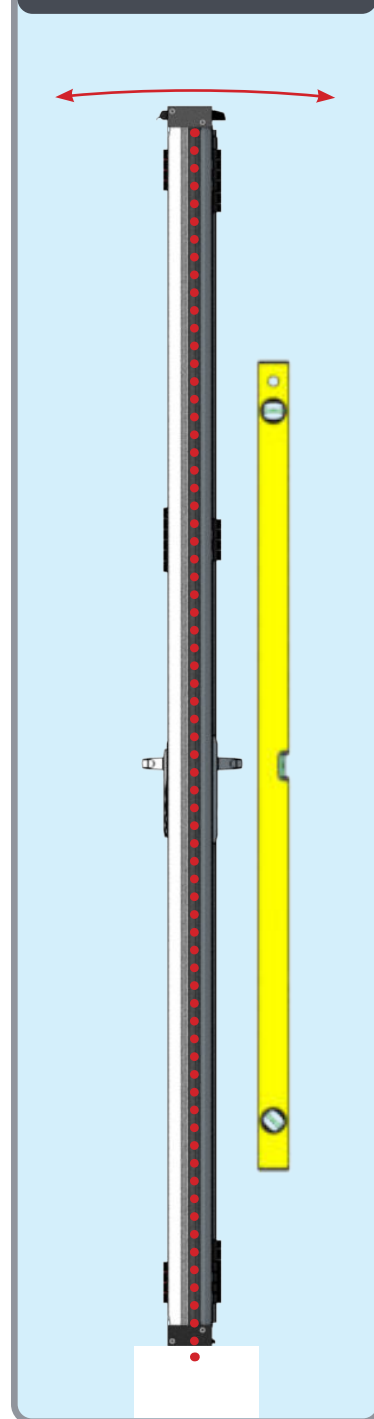

3 Horizontal alignment

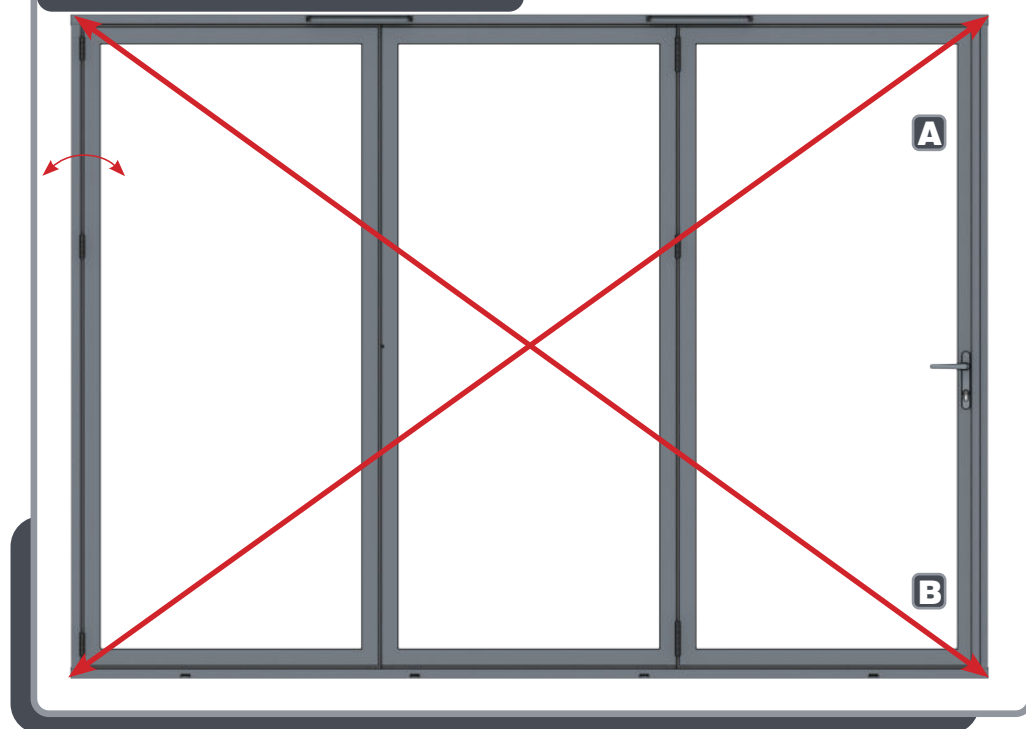

Ensure diagonals: $A=B \pm 1\text{mm}$

DOOR INSTALLATION

A5



Outer frame packers
(not supplied)

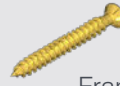

Frame fixing screws
(not supplied)



Low modulus silicone sealant
(not supplied)

4 Packing of outerframe

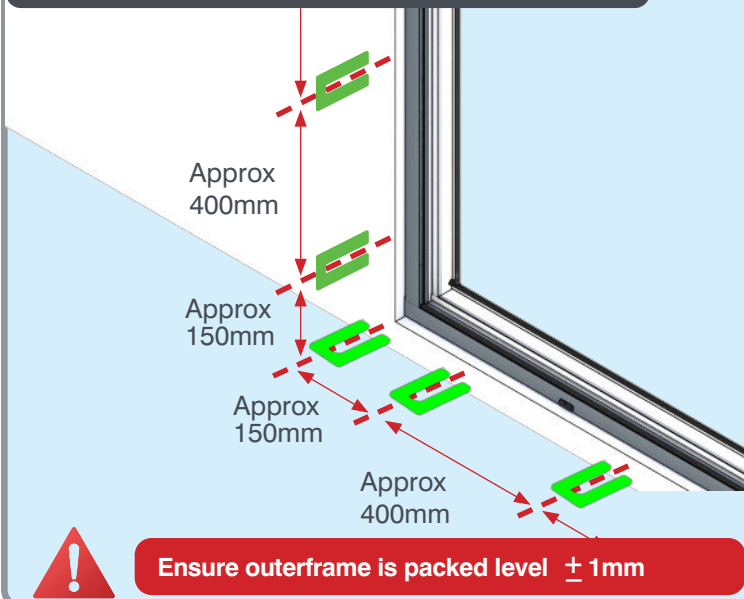

5 Drill and screw outerframe in position

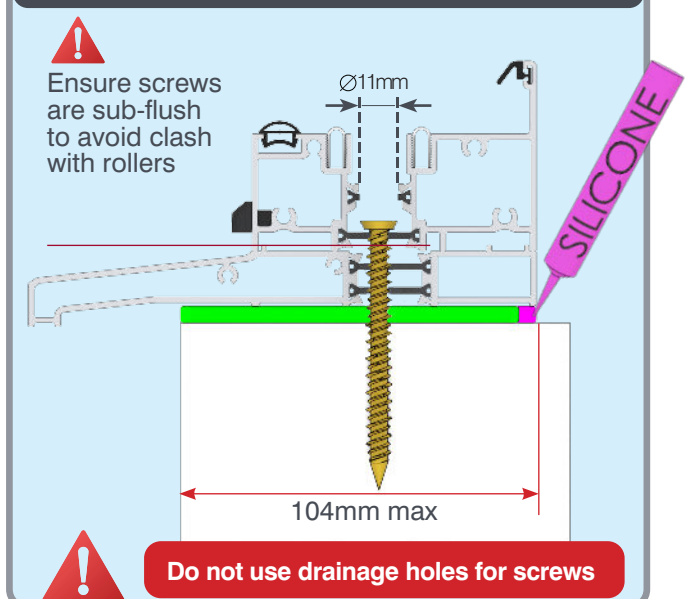

6 Check vertical measurements

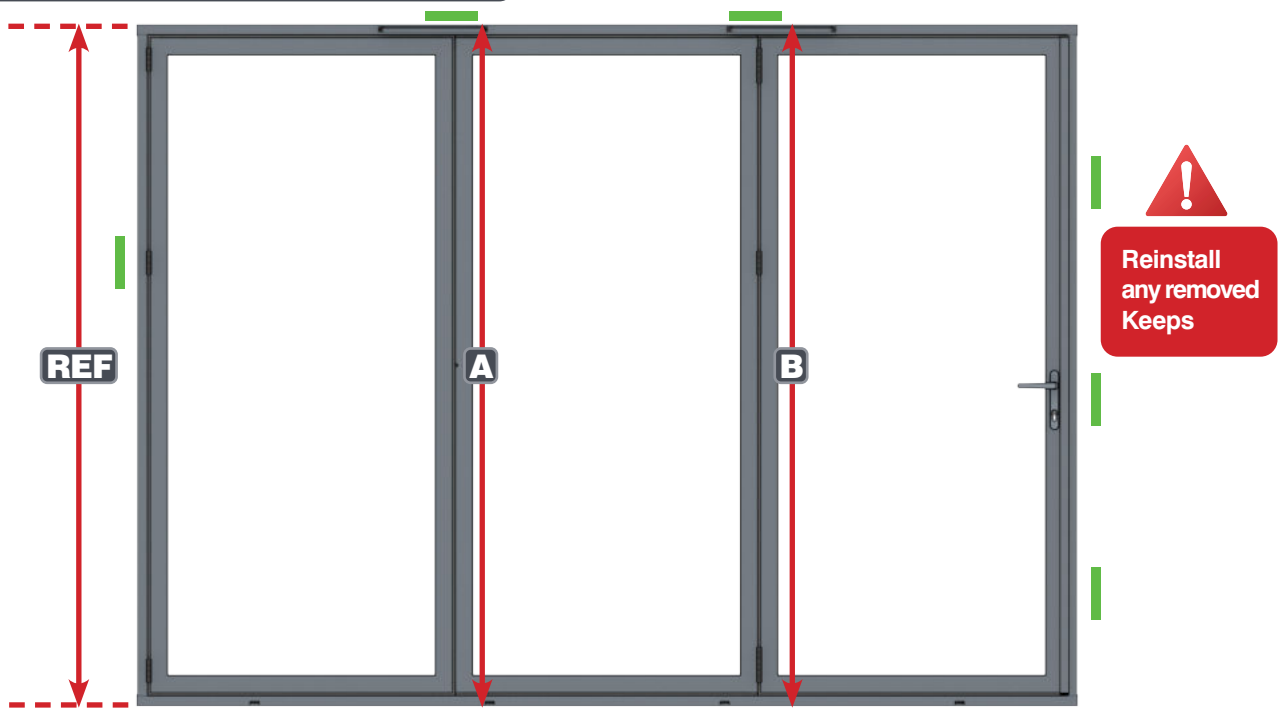

Ensure verticals: REF=A=B ± 1mm
Extra packers at locking points and hinges

DOOR GLAZING



Horizontal beads

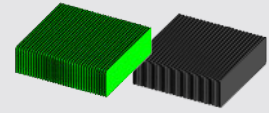
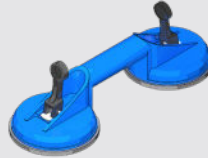

Glazing packers

2 Glazing of sashes

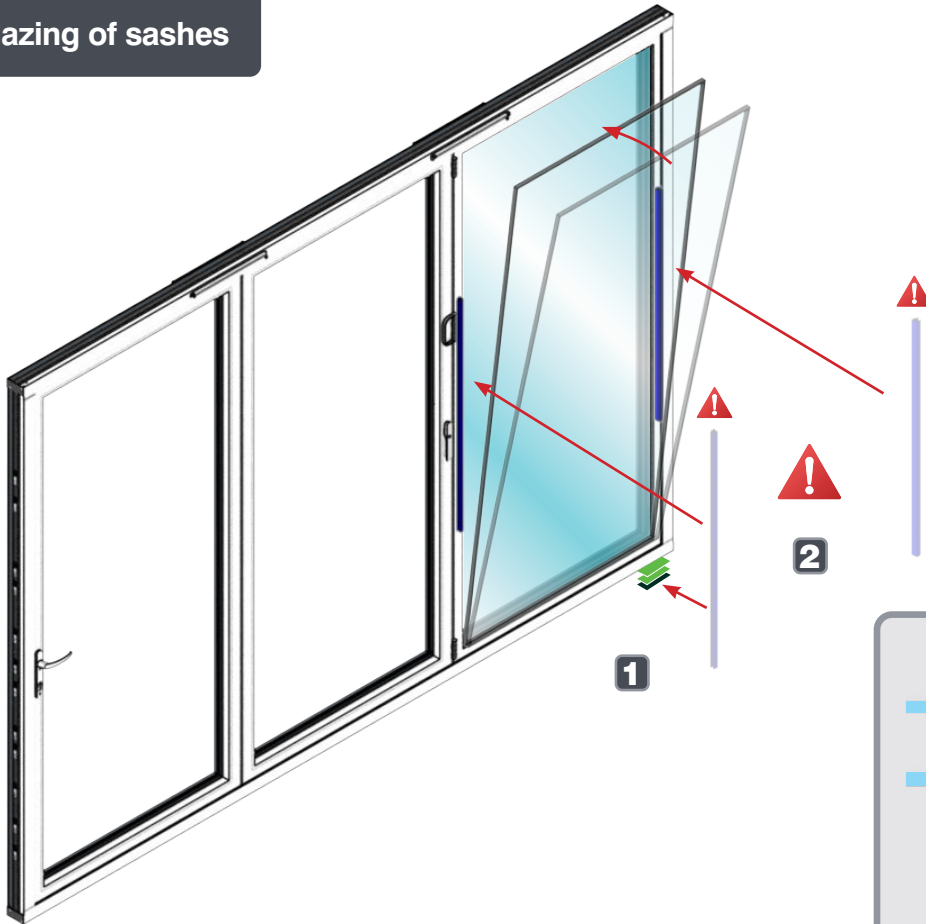

Suggested Packing

1mm	↑	↓	
1mm	↑	↓	
2mm	↓	↑	

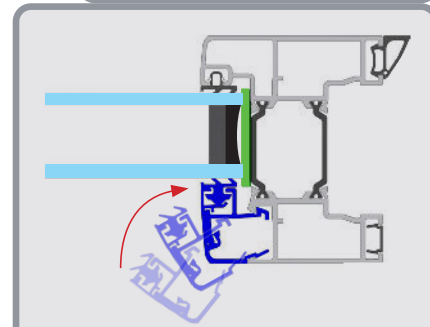

Tip: Use horizontal beads to temporarily secure glass: Refer to appendix 2

Toe and heel adjustment



11mm

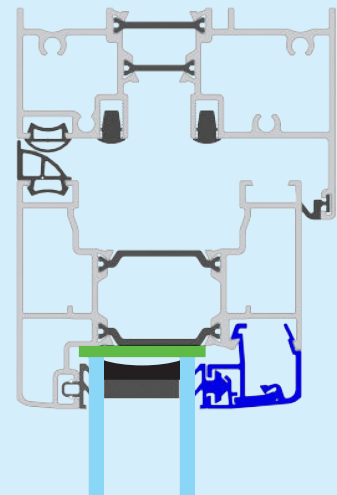

Adjust sash packing to maintain 11mm all round

DOOR FUNCTIONALITY

A6

19mm 1:1

A-03309 -
Final hinge screw



Shootbolt key
A-03883

1 Check door functionality



2

Final screw
fixing



Adjust hinge height if required so sashes are inline and gaps are equal to 11mm then install final hinge screws



ADDITIONAL PACKING AND REFITTING BEADS

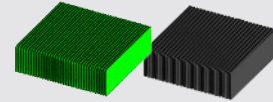

Optional additional
Glazing packers

3 Pack at locking and hinge points



4 Clip-in bead installation

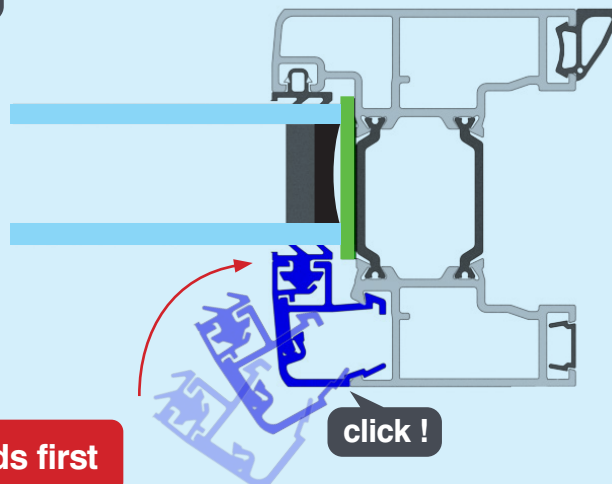

Fit horizontal beads first

click !

DOOR MAGNET INSTALLATION

A7



3mm Drill Bit



Magnet
A-03948

2 Door magnet installation

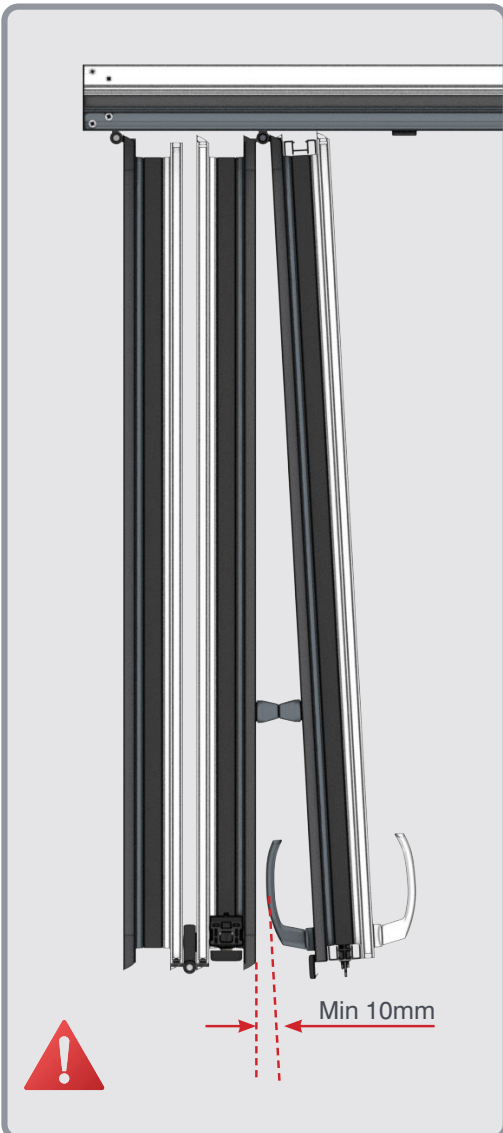

Position magnet to ensure 10mm gap



Position grub screw opposite hinges and adjust angle to ensure magnets touching faces are parallel.

LOCK ADJUSTMENT

B1

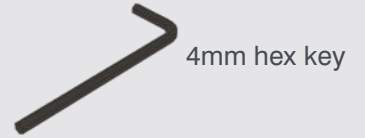

Before adjusting lock ensure door frame and glazing is correctly packed

1 Latch plate adjustment



2 Roller cam adjustment using 4mm hex key

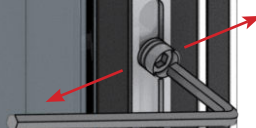

3 Hook keep adjustment using 4mm hex key

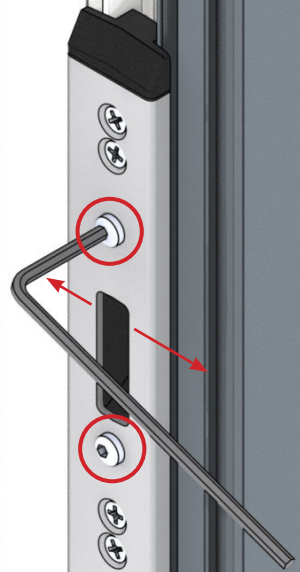

KIT-FORM ONLY ASSEMBLY

KF

C1

60mm 1:1

A-03310



1



First remove any frame extenders, retaining screws for later

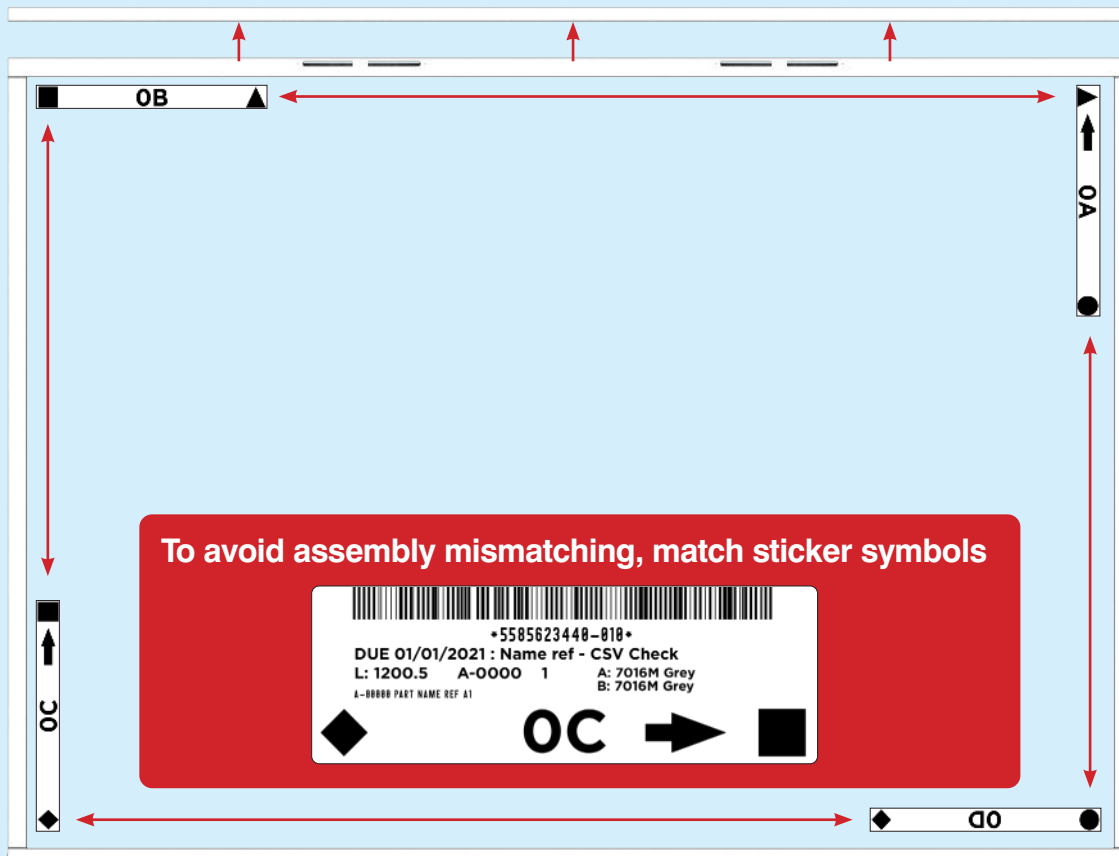

2 Outerframe assembly

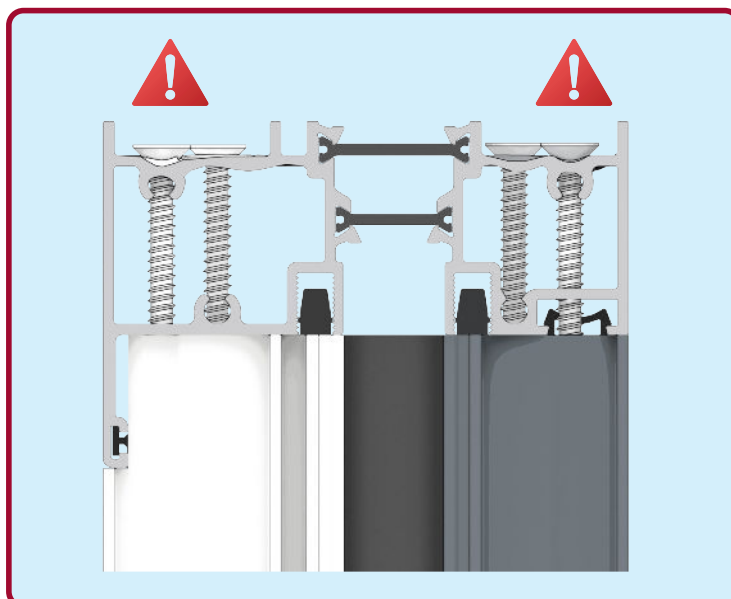
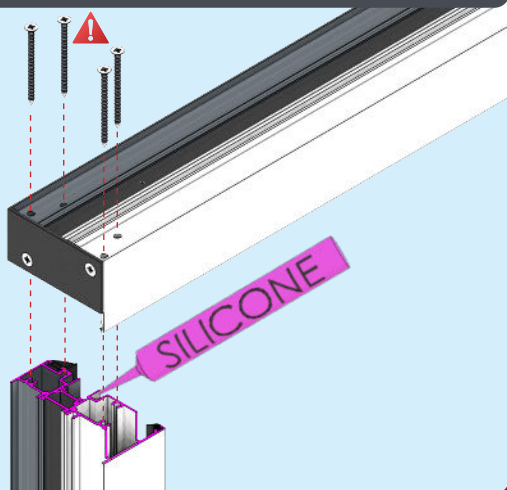

To avoid distortion do not over-tighten

OUTERFRAME ASSEMBLY

KF



A-3732



3 Re-attach optional frame extender

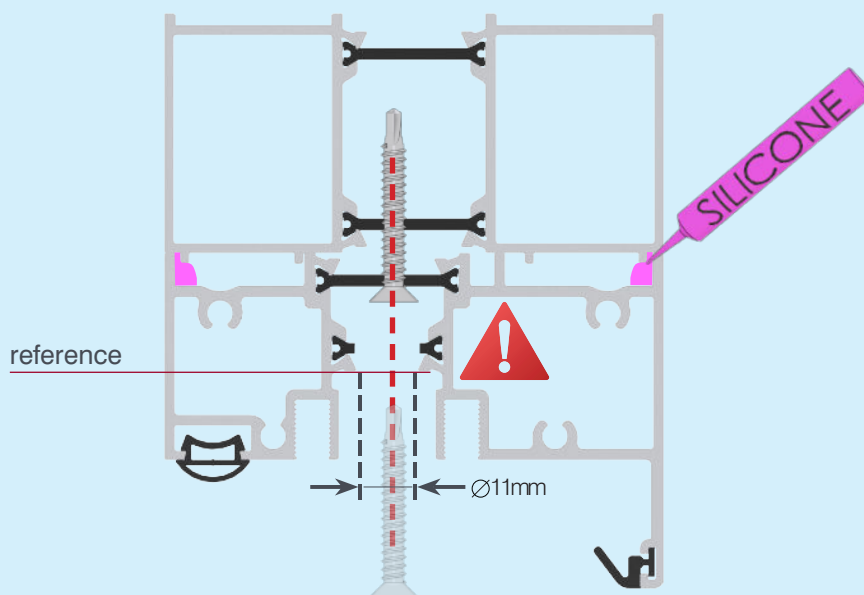

Ensure screws are sub-flush to reference line

4 Fixing position of optional frame extender to outerframe

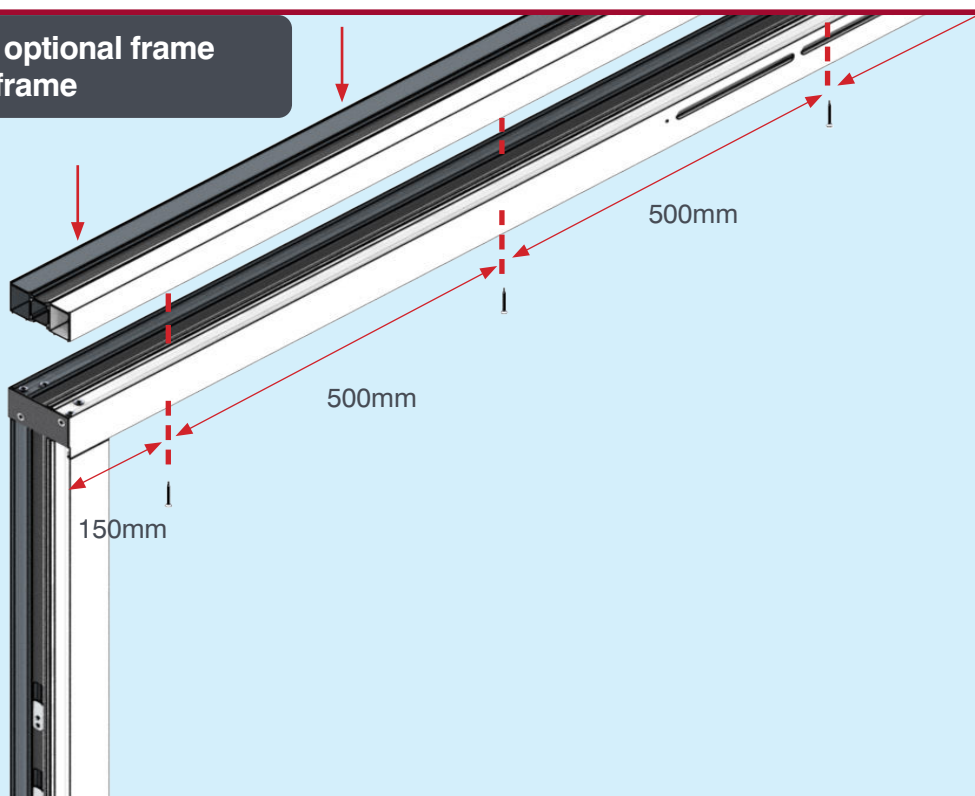

C2

Rotate sash into position

Top of frame

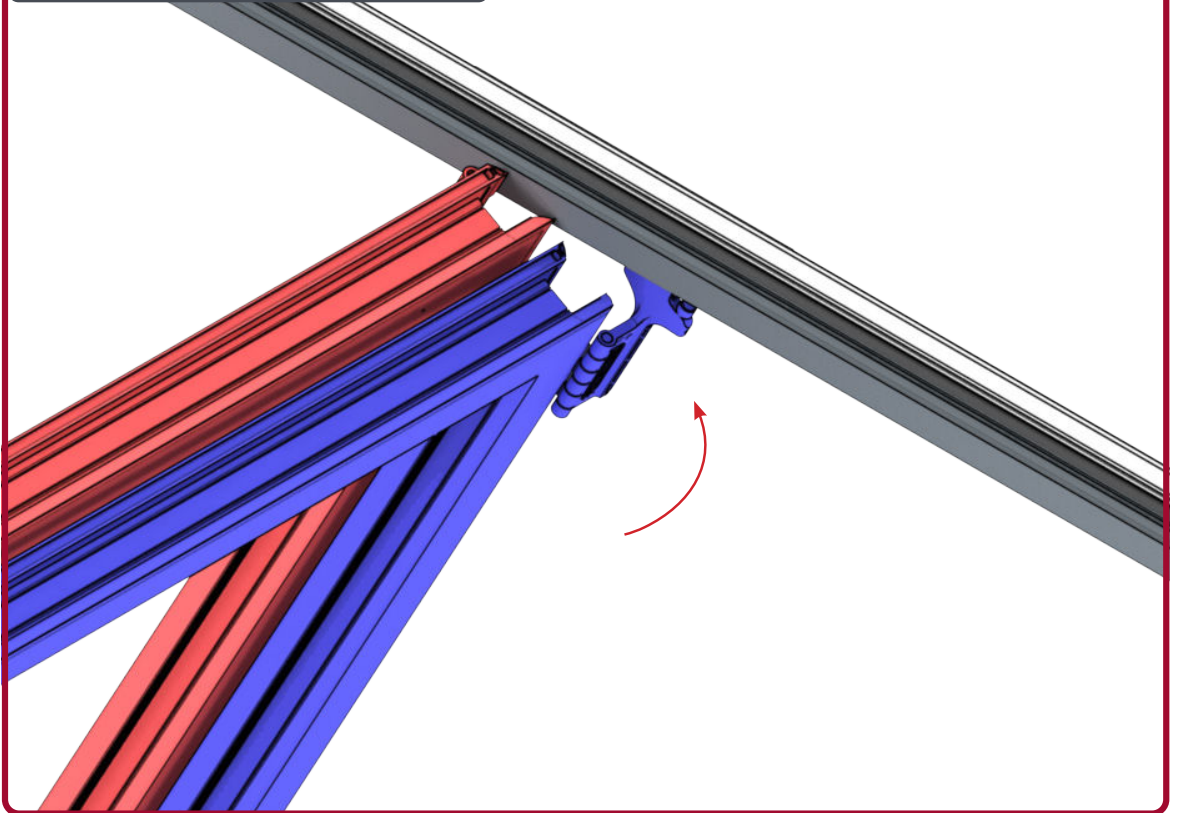

Bottom of frame

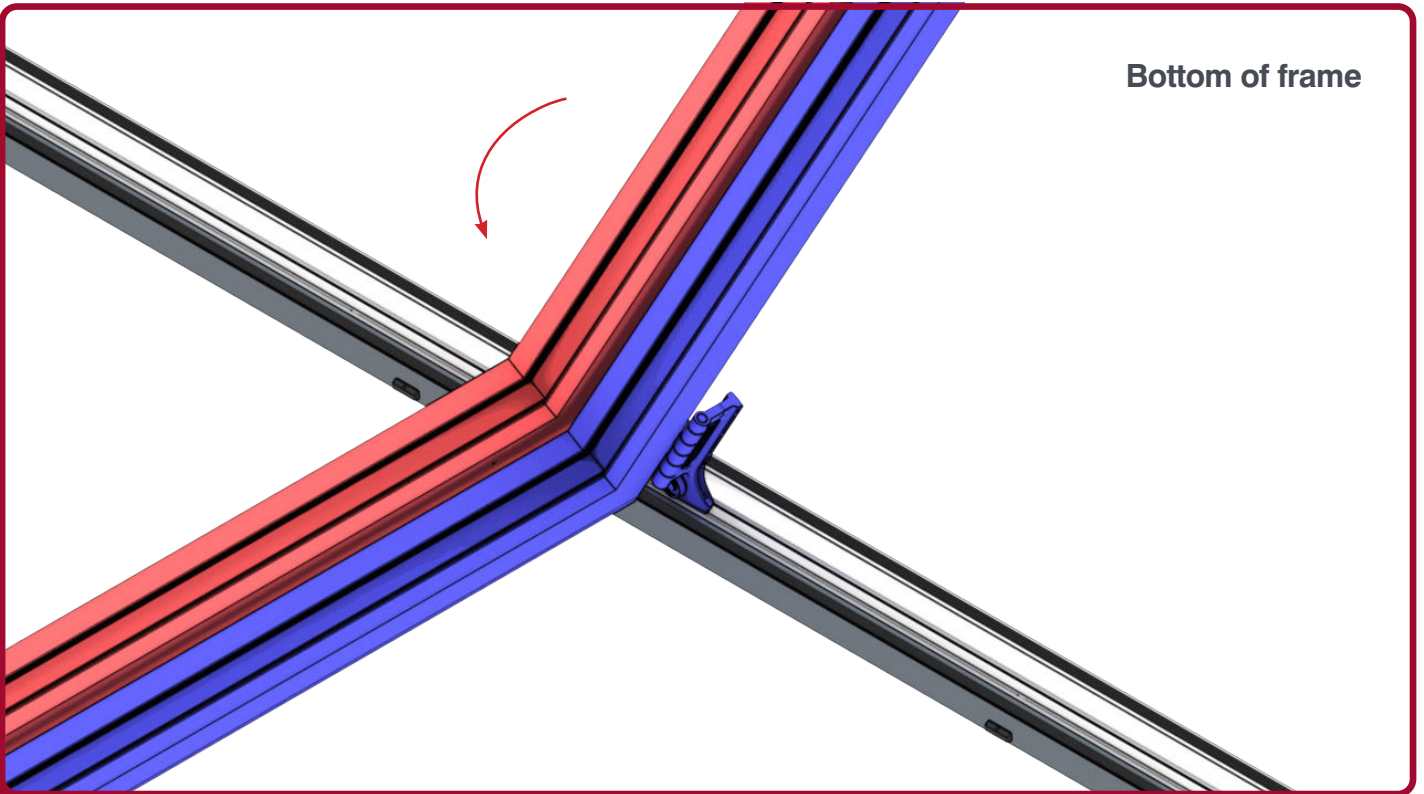

SASH INSTALLATION

KF

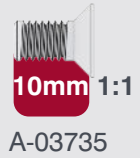

Sash attachment - external view

 Do not install centre screw **A** until stage A6

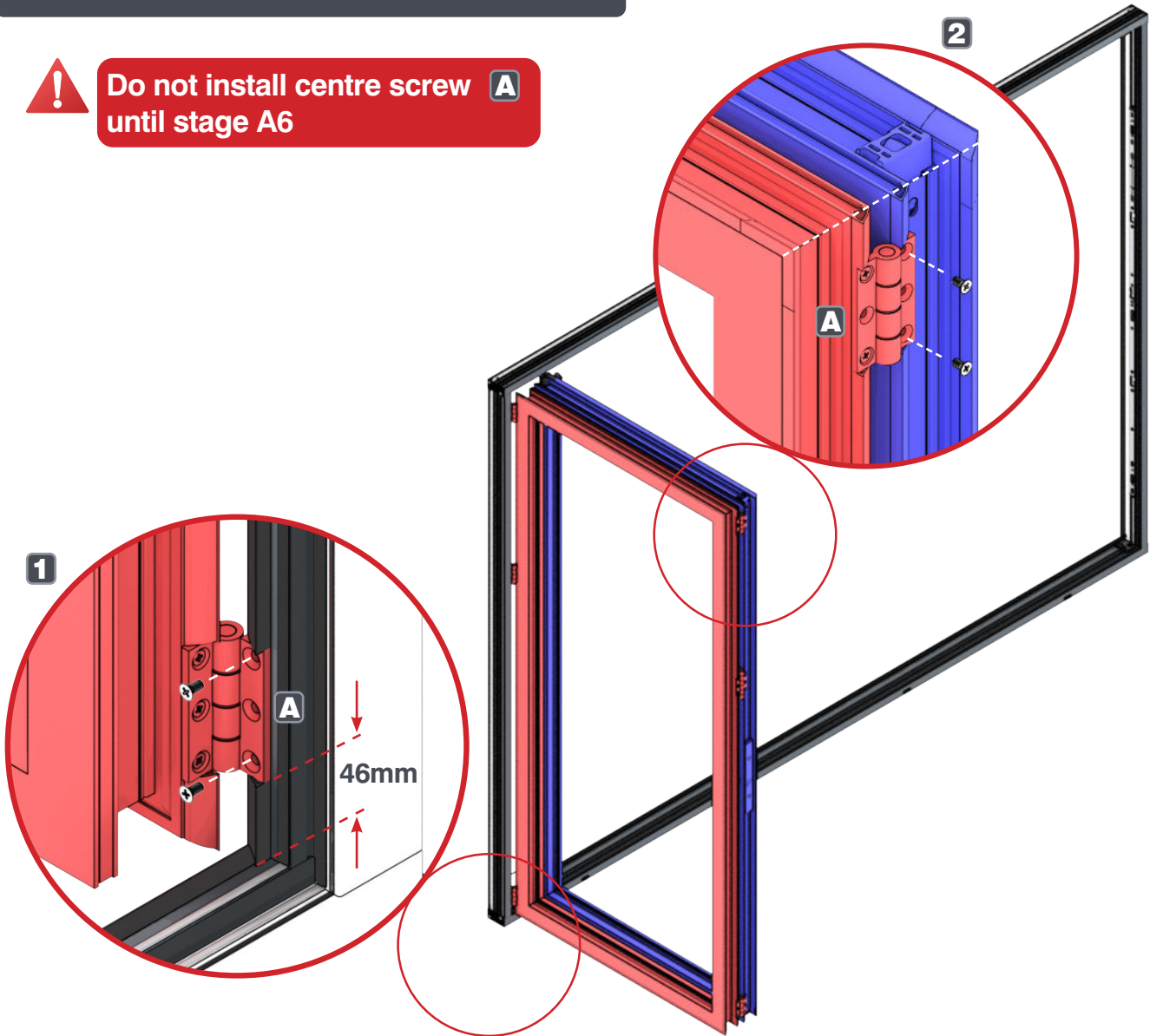

Align sashes using hinge screws to adjust heights (sashes are numbered left to right from outside)



End of Kit-form instructions

BEAD REMOVAL WHEN REGLAZING

D1



De-glazing tool
A-00424

! Ensure tool and glass are clean to avoid scratches

Bead removal order

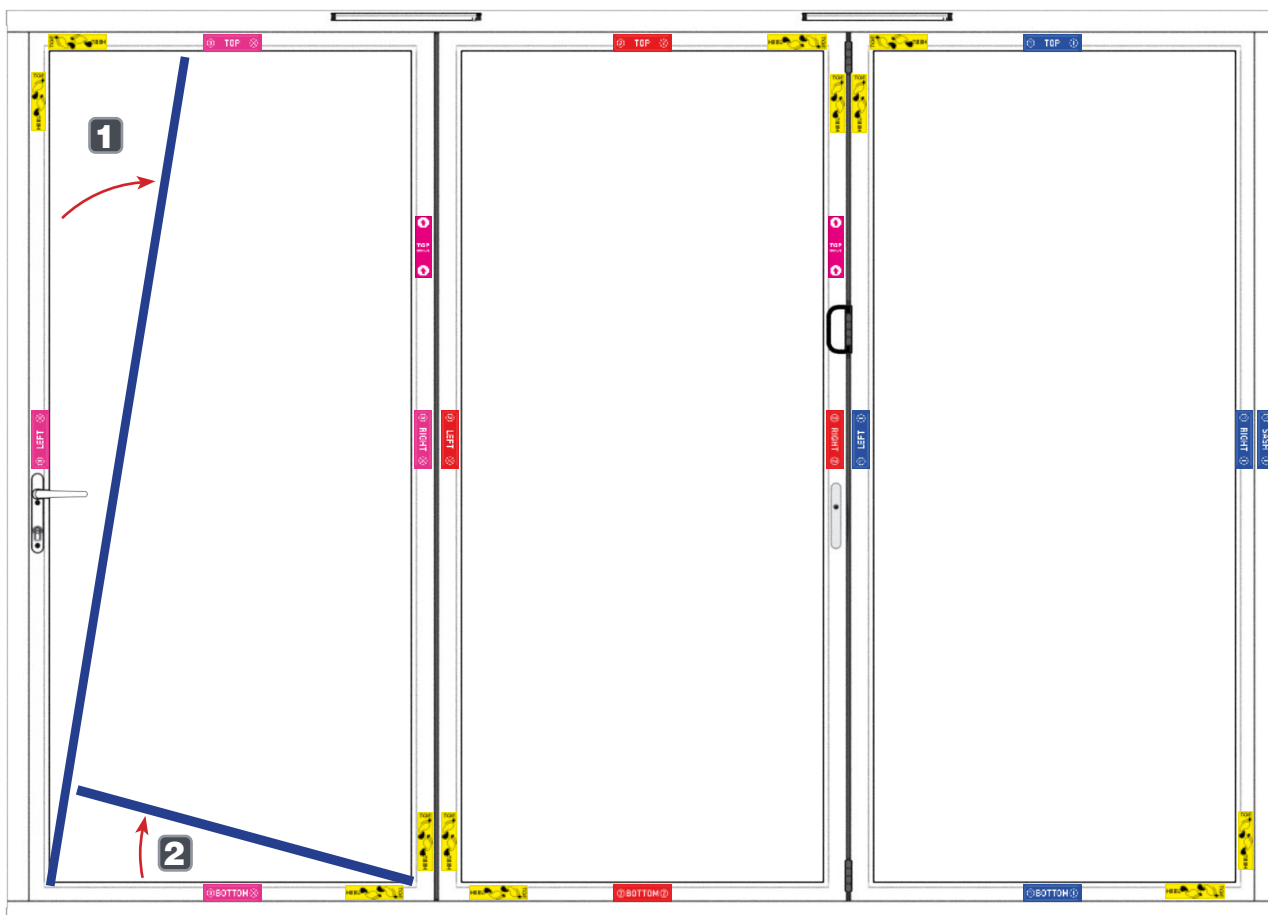

1 Push tool into seal

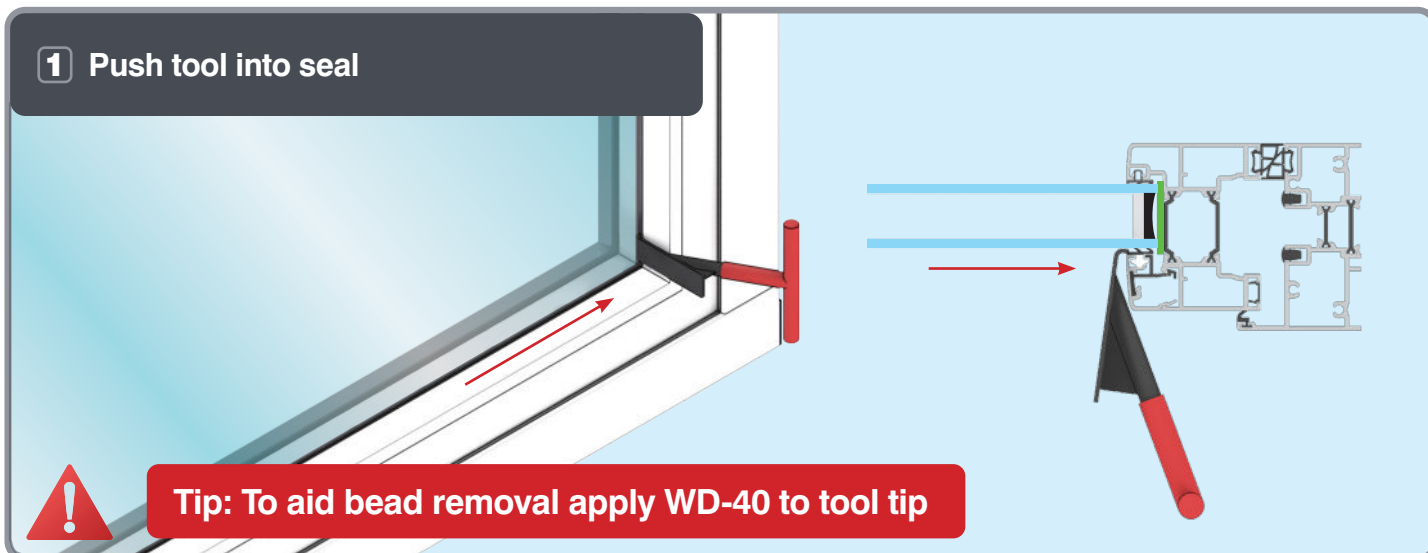

Tip: To aid bead removal apply WD-40 to tool tip

BEAD REMOVAL WHEN REGLAZING

2 Maintain pressure and rotate handle towards glass

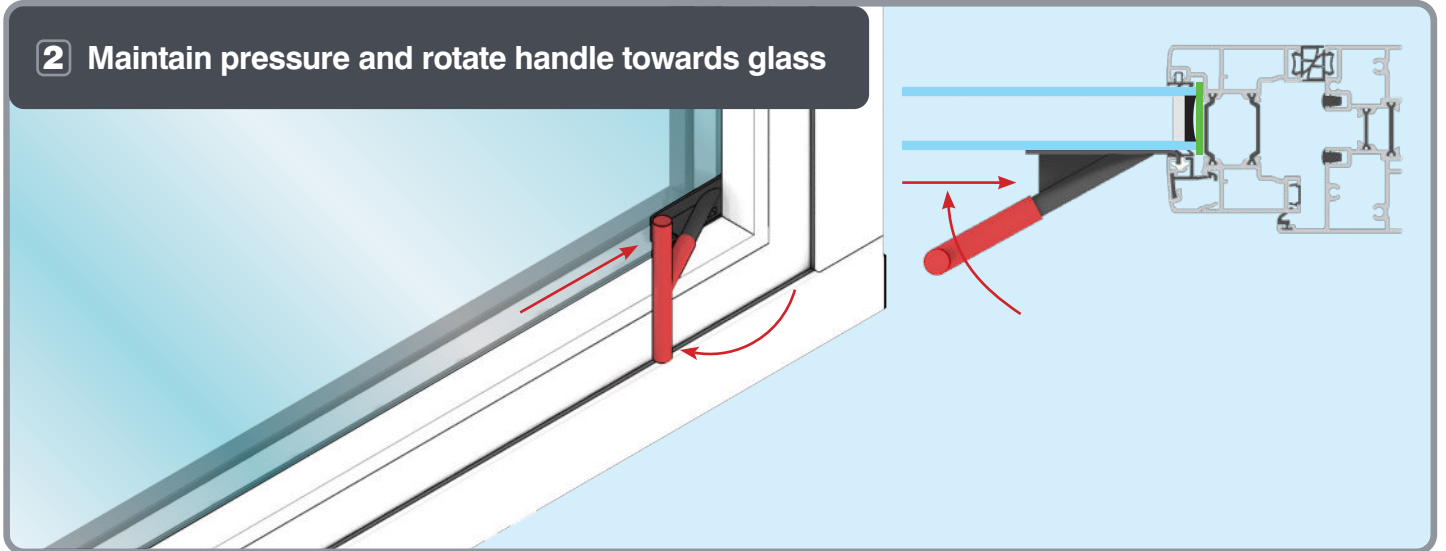

3 Rotate tool to engage tip

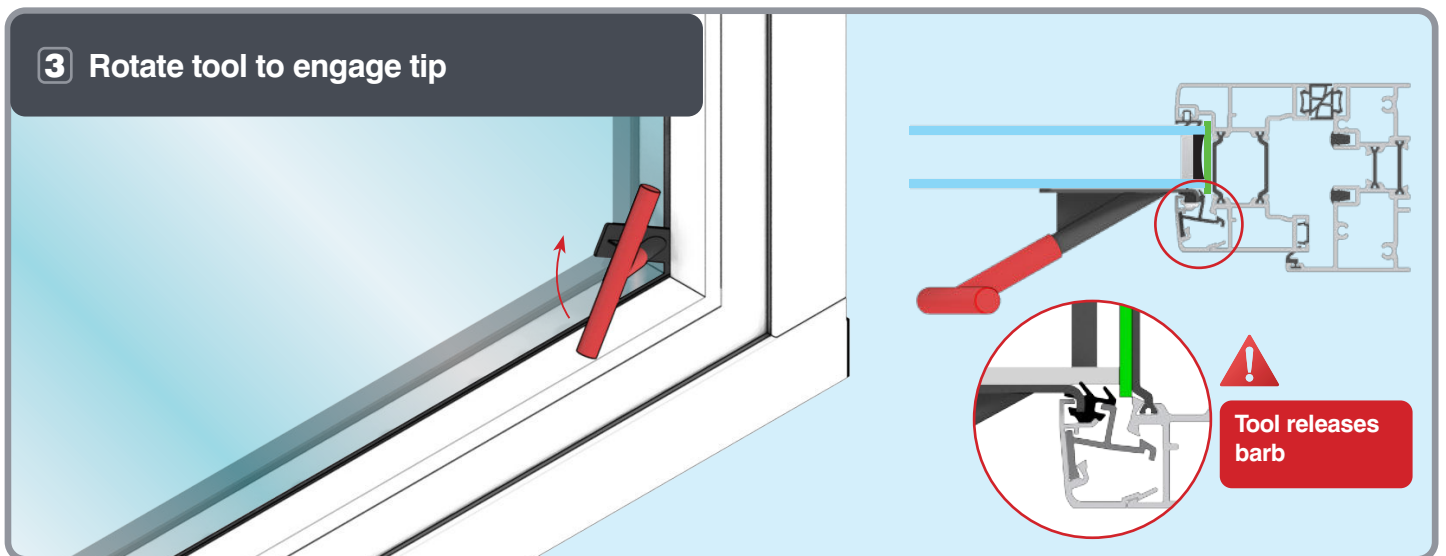

4 Pull along the glass direction to release

