

Korniche Roof Lantern

Installation Guide

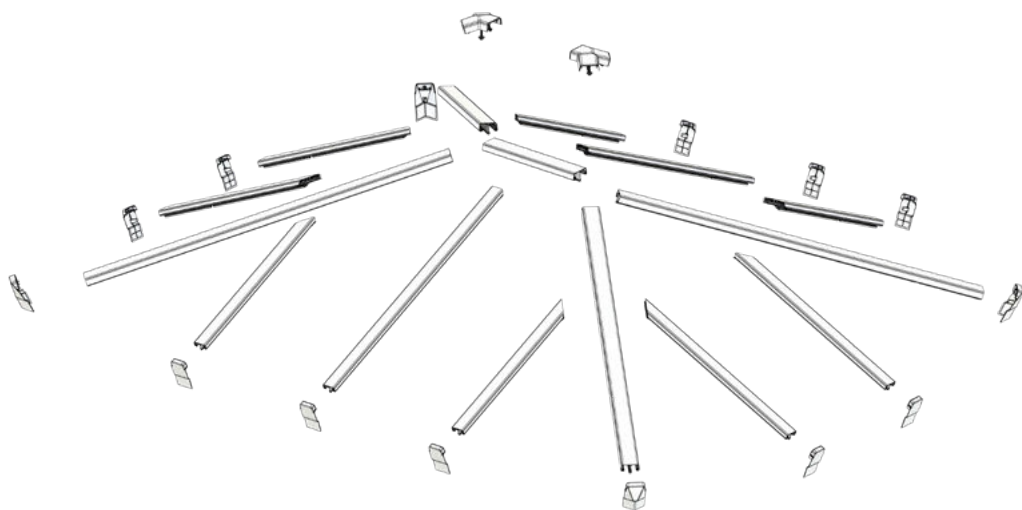

TOOLS REQUIRED



Soft mallet



Cordless Screwdriver



T40 Security PZ2 Bit
A08445

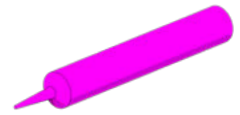

Low Modulus
Silicone Sealant

PACKAGING CONTENTS

Packing contents
will vary depending
on configuration



Eaves Beams



Ridge Rafters



Ridge



Hips



Jack Rafter



4-Way Boss



Glazing Retainer



3-Way Boss Top Caps



4-Way Boss Top Caps



Hip Top Caps



Ridge Top Caps



Rafter Top Caps



Hip End Caps



Rafter End Caps



Eaves Screws



Eaves Corner Screws



Rafter Bolts



Eaves Screw Covers

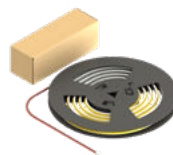

LED Kit(s)



De-glazing Tool

BUILDING THE EAVES RING BEAM

1



Slide the width eaves into the length eaves beam

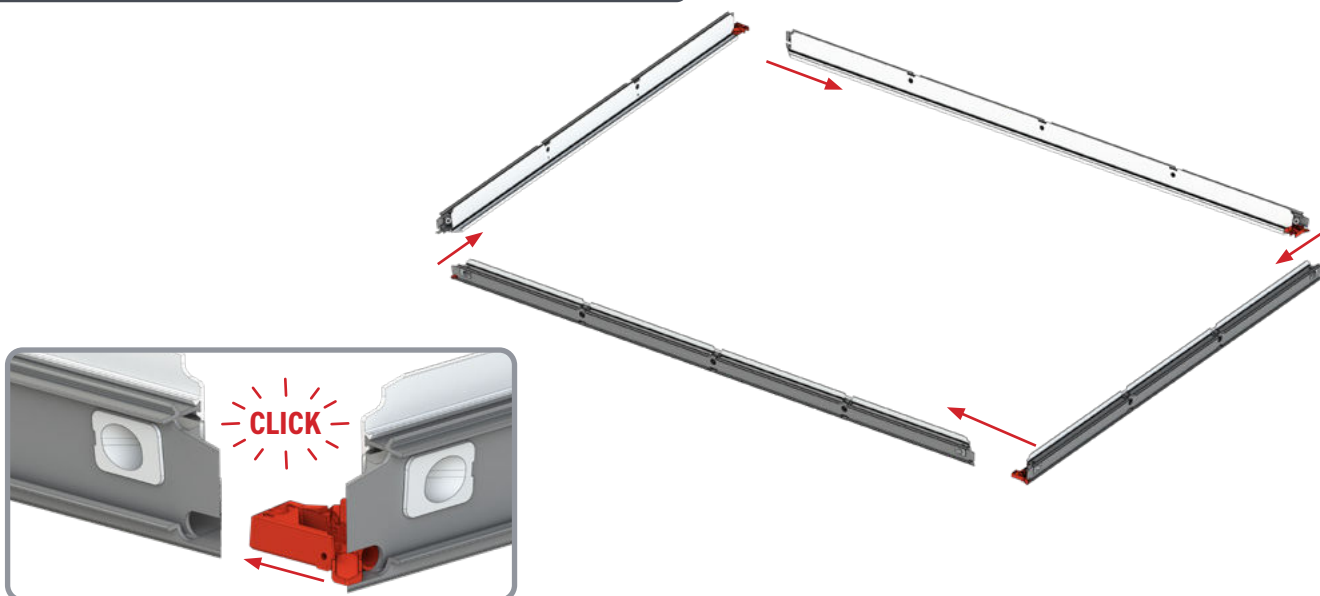

Position assembly onto upstand

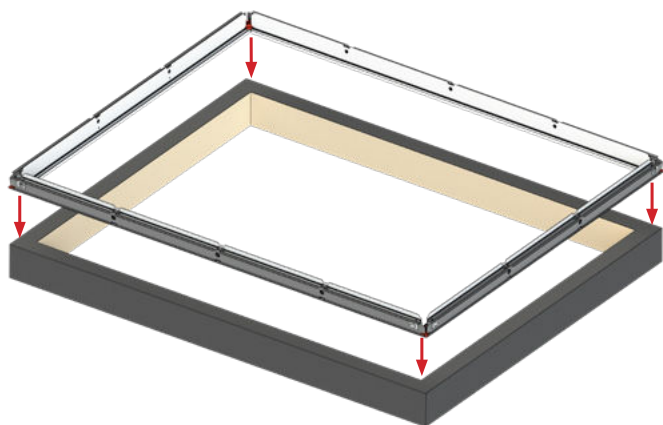

Pull open each corner

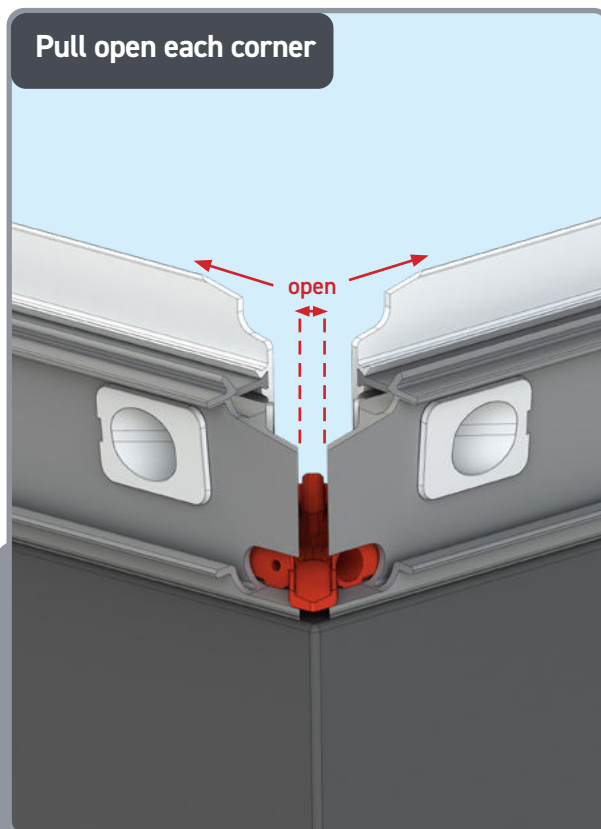

OPTIONAL - FITTING LED STRIP LIGHT

2

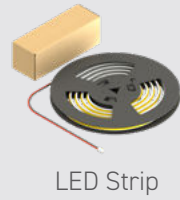

Install LED strips around the eaves beams

1

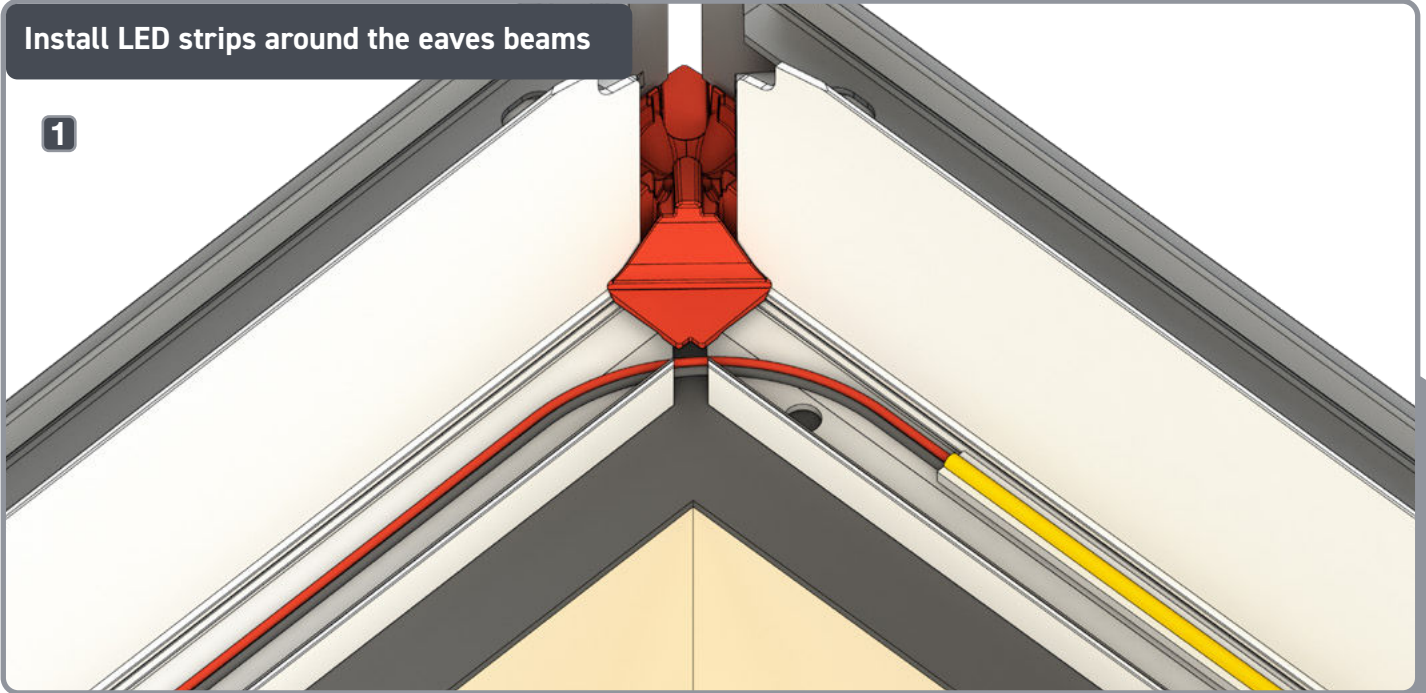

Thread power supply cable through hole

2

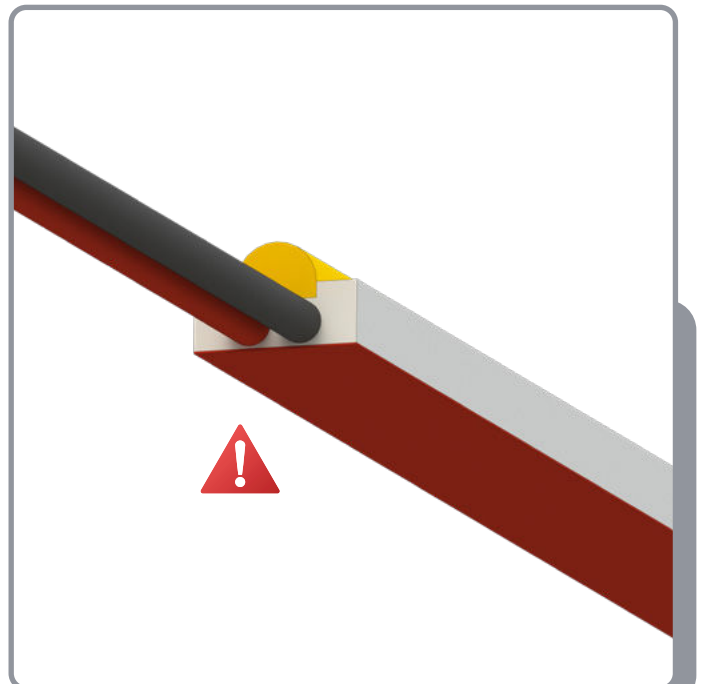
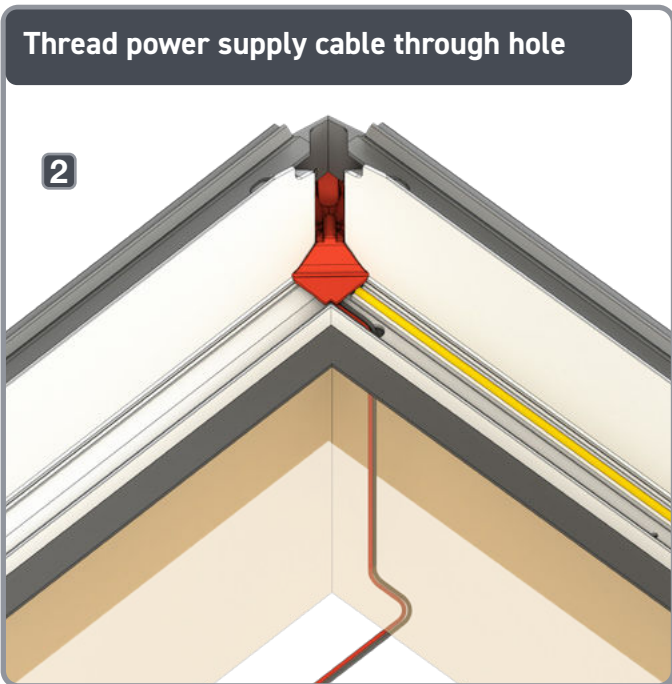

DO NOT peel off tape.

SPIDER ASSEMBLY - RIDGE AND HIPS

3



Cordless
Screwdriver



Ridge

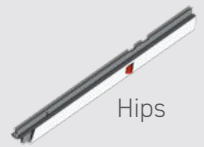

Hips



T40 Security PZ2 Bit

Identify correct hips first

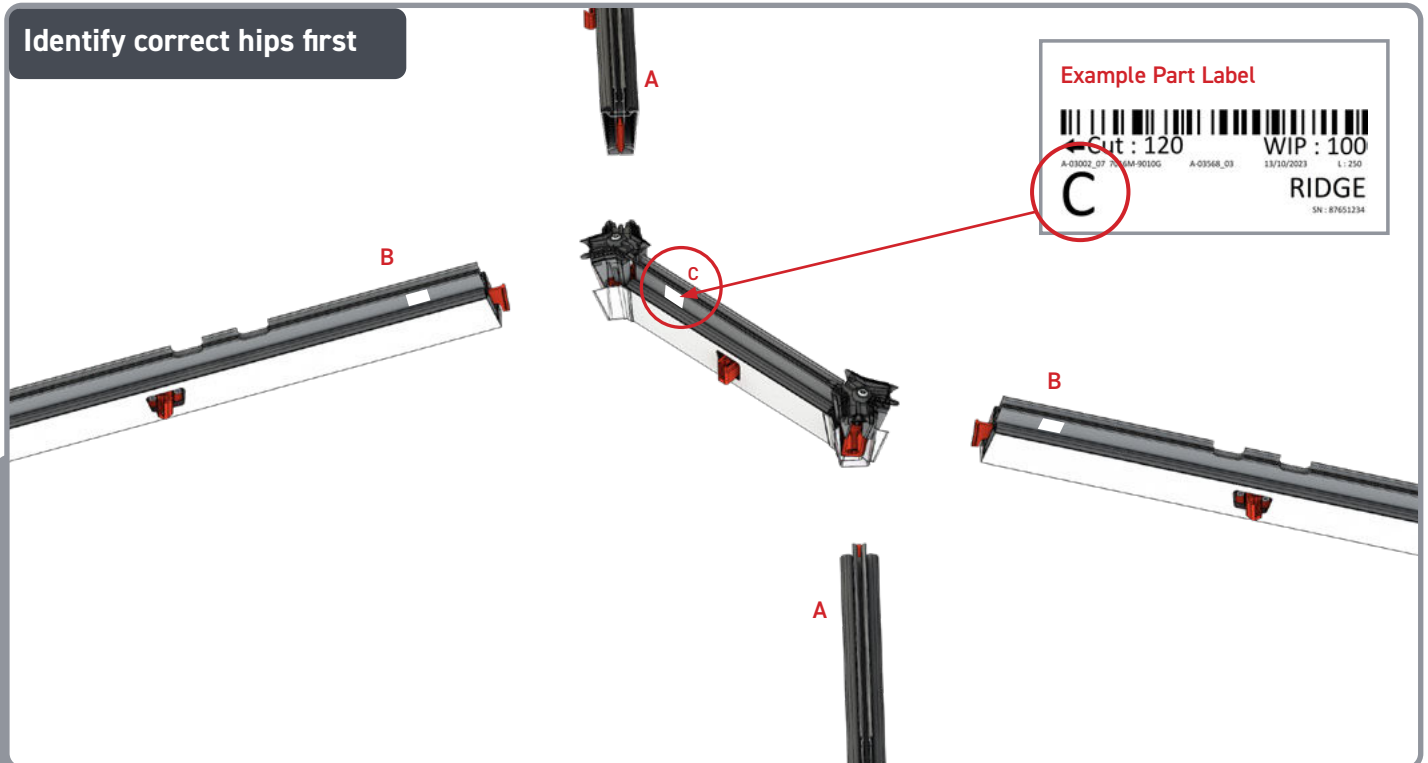

Insert the hips

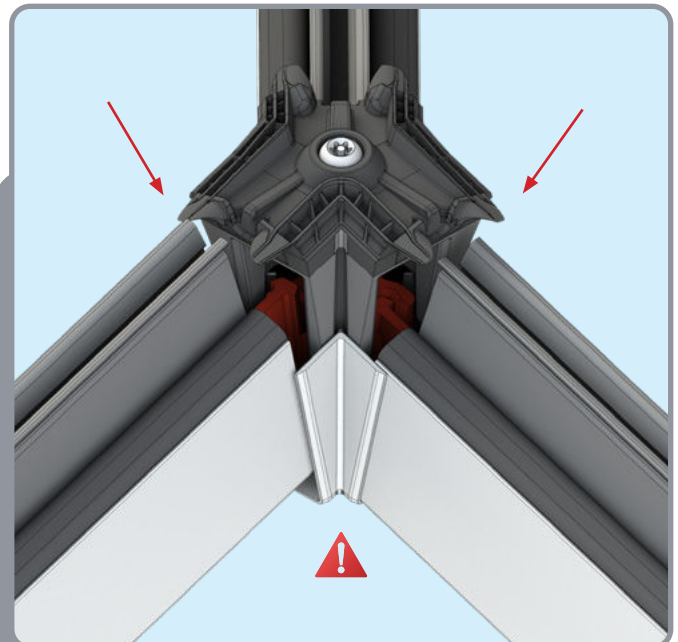
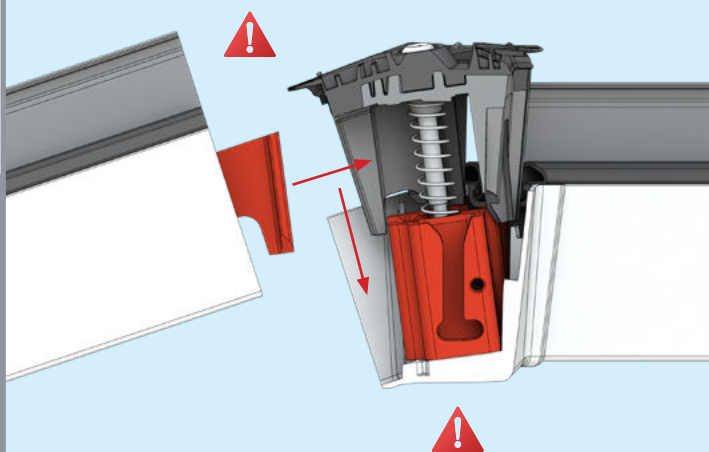

Hold at correct angle and insert - Support with hand.

Support bottom of boss with hand, close sealing face with thumb, tighten central bolt

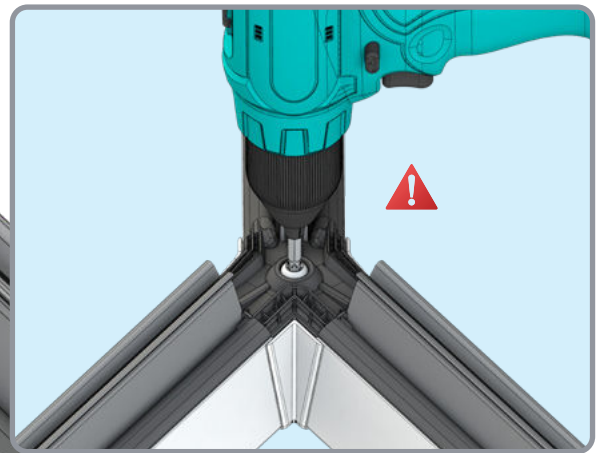
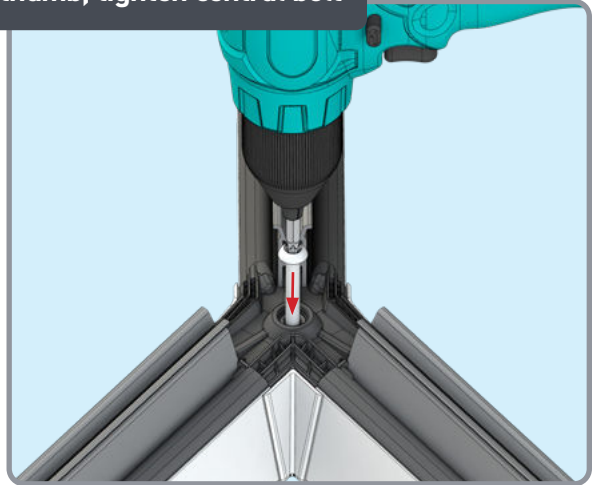
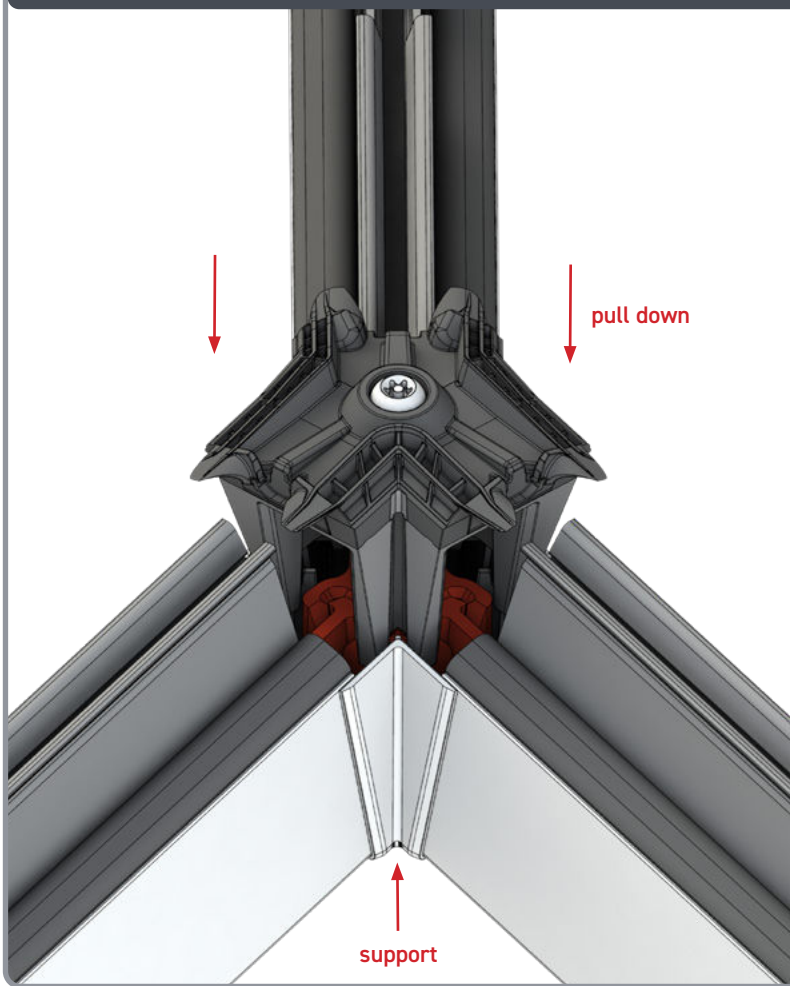

DO NOT OVER-TIGHTEN - use low torque setting.

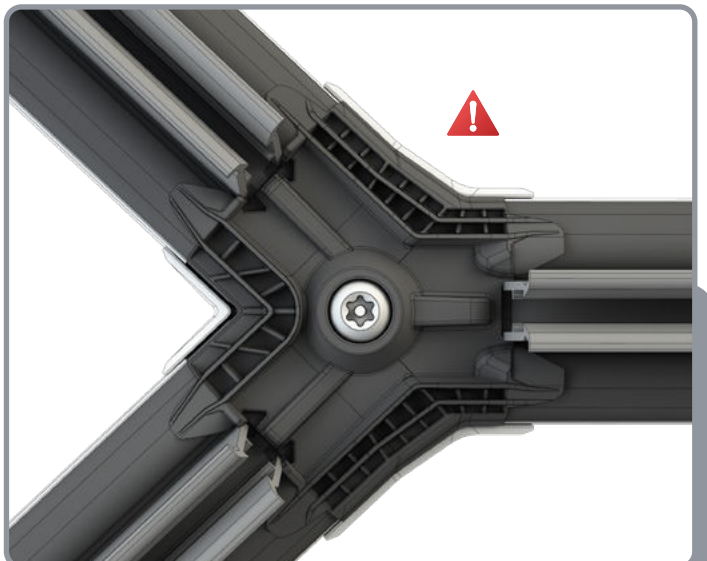
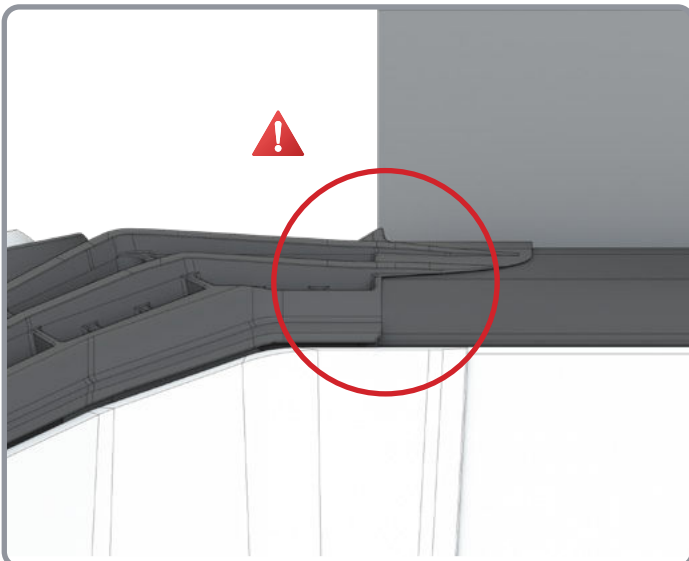

Ensure seals are correctly seated. Boss seals must overlap.

SPIDER INSERTION

4



Cordless
Screwdriver



Eaves
Bolt



T40 Security PZ2 Bit

Lower spider into eaves beam

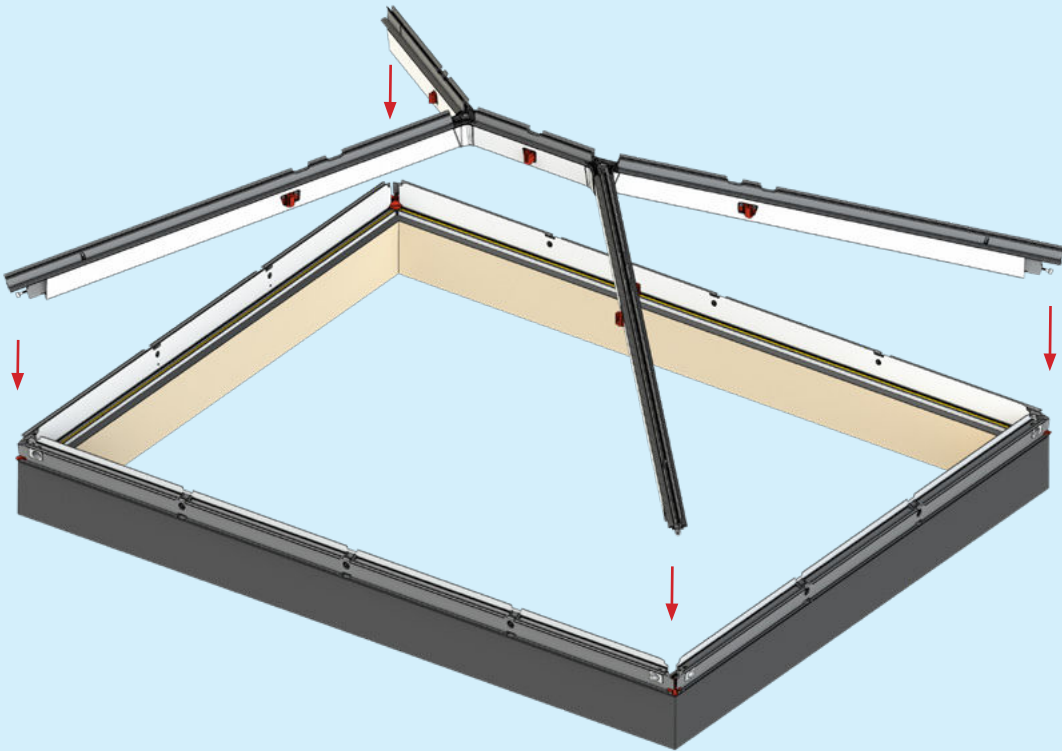

1 Drop spider in place

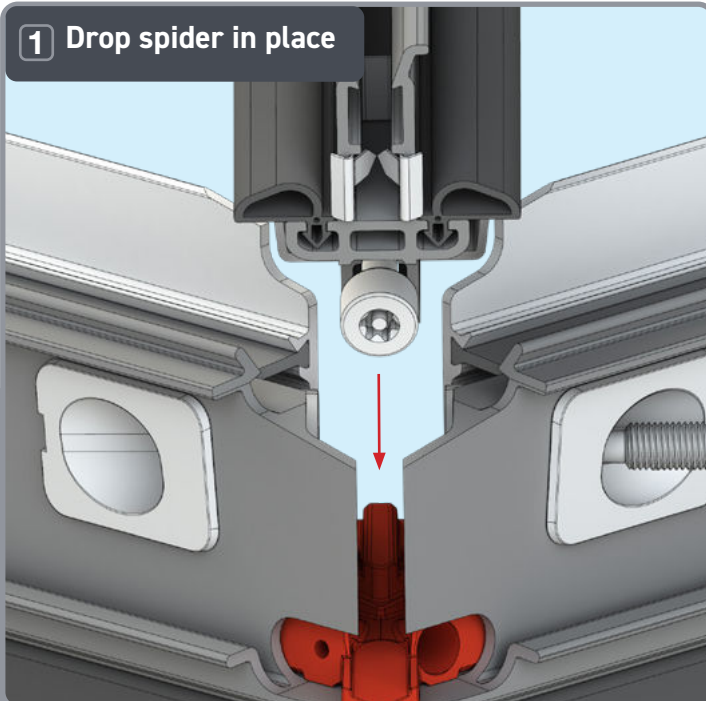

2 Insert corner bolt - thread just 2 turns

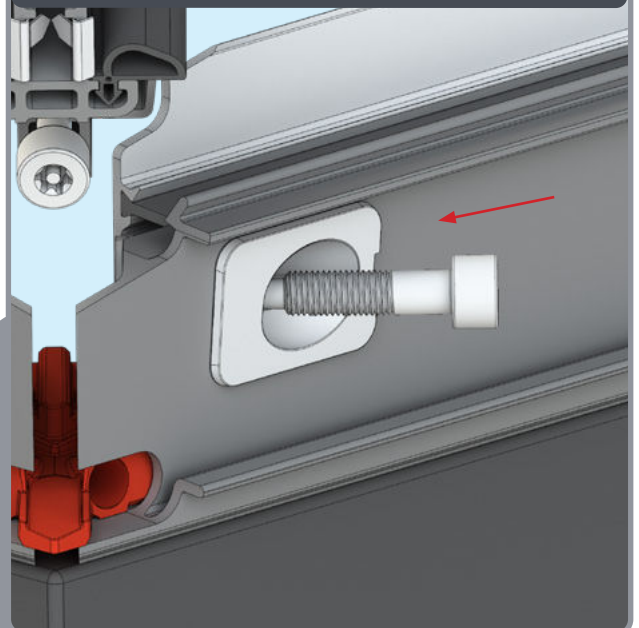

OPTIONAL - RIDGE RAFTER

5

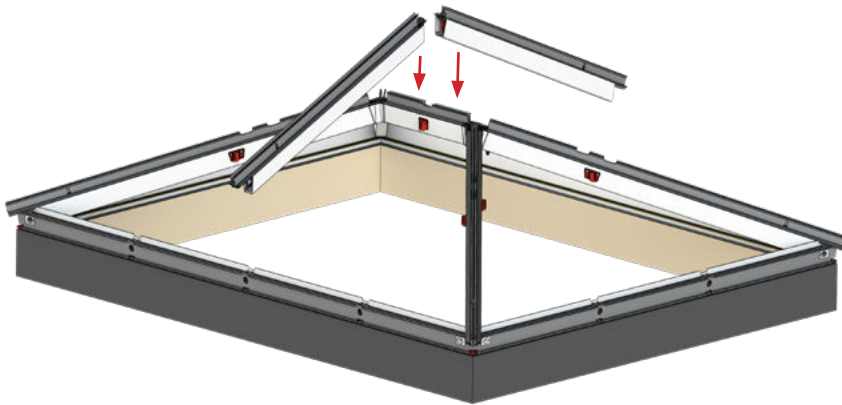

Slide U channel down before installing

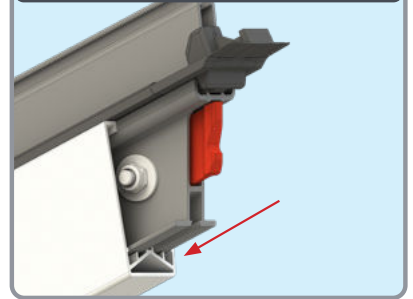

Insert into the ridge receiver - click into place

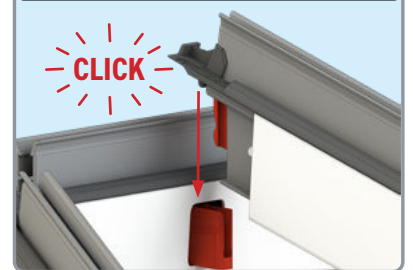

Slide U channel back once in place

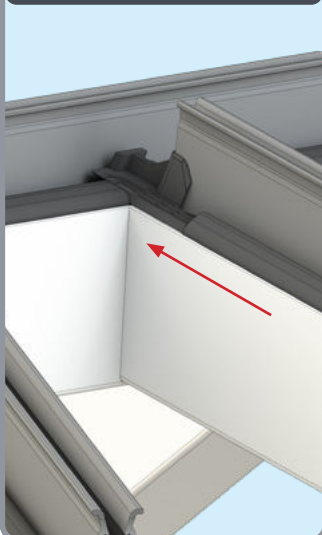

Pull for clearance



Lower and ensure firmly seated

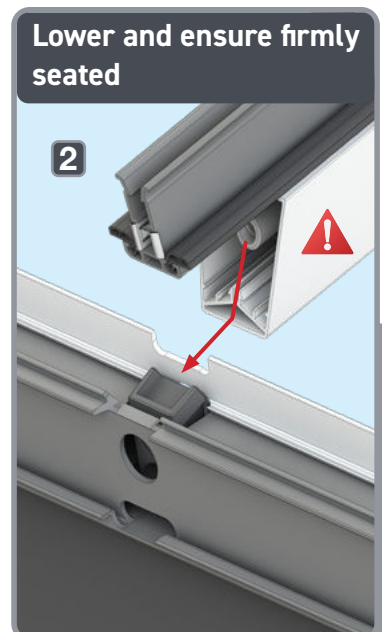

Ensure stub locates in hole. Do not scratch eaves beams when sliding rafter into position.

OPTIONAL - JACK RAFTER INSTALLATION

6



Jack Rafters

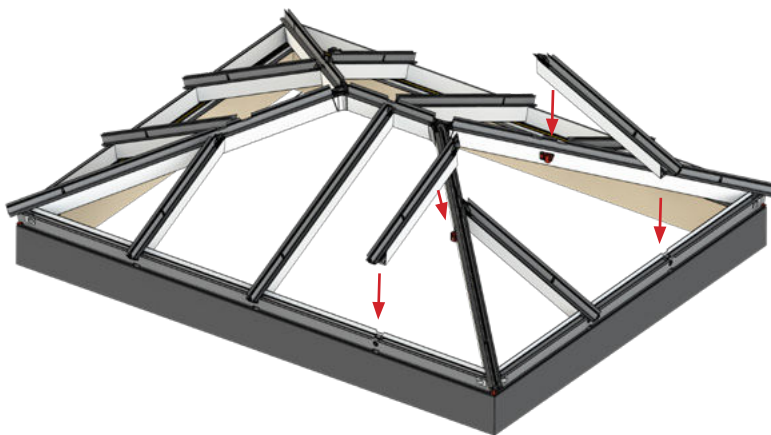

Slide U channel profile down before installing

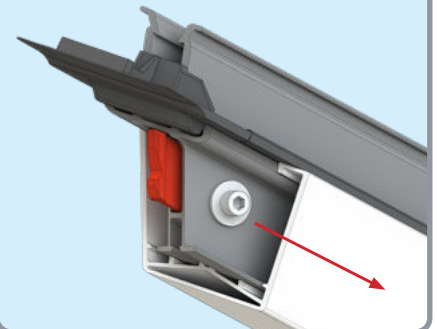

Click hip jack rafter receiver into the hip



Slide U channel back once in place

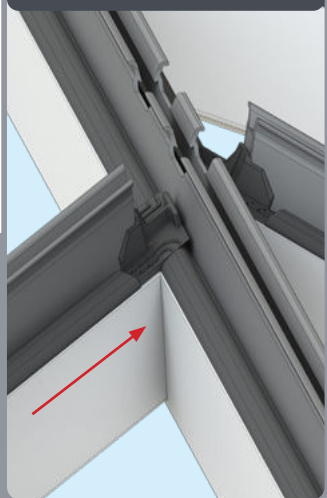

Pull for clearance

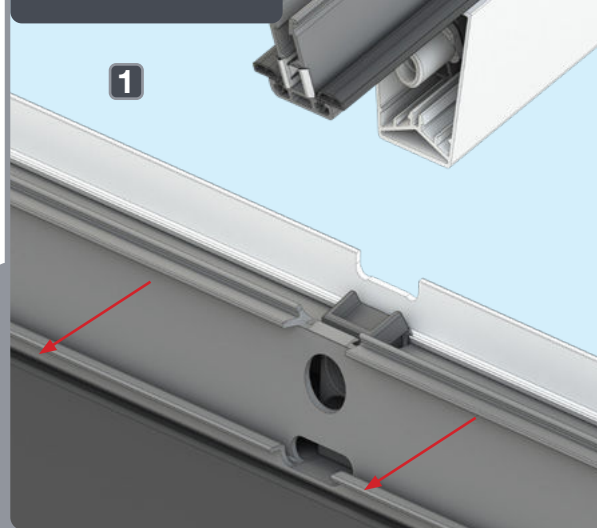

Lower and ensure firmly seated

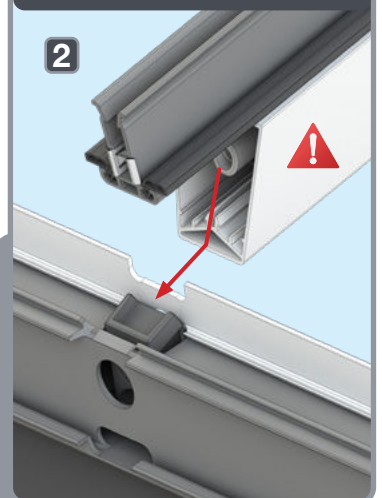

Ensure stub locates in hole. Do not scratch eaves beams when sliding rafter into position.

SPIDER FIXING

7



Cordless
Screwdriver



Rafter Bolts



T40 Security
PZ2 Bit

Install all rafter bolts

1

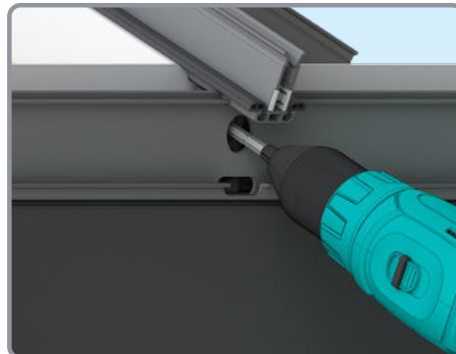
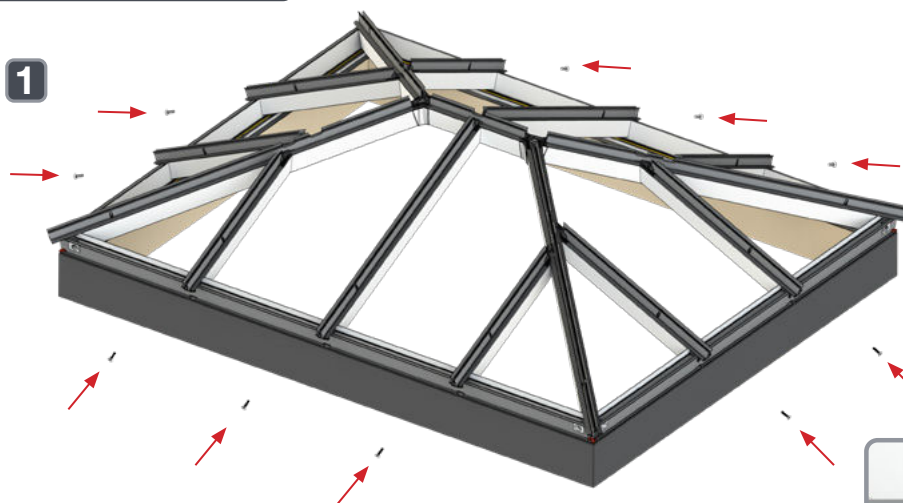

Tighten bolts in the order shown:

2 Corner bolts

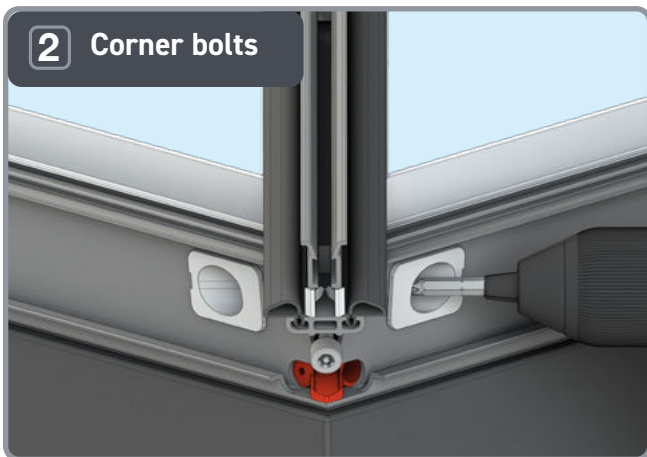

3 Adjuster bolts

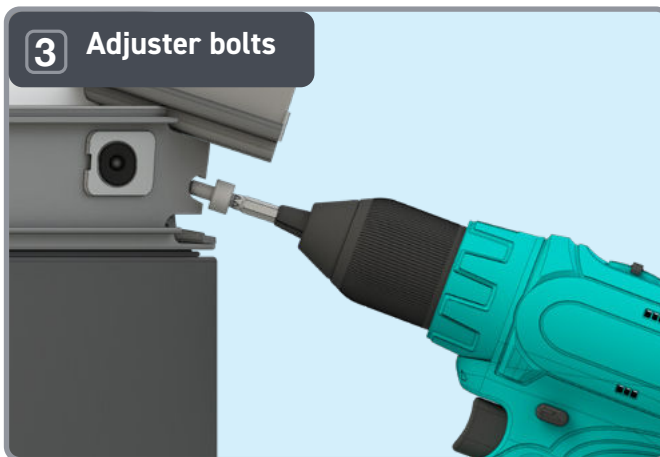

DO NOT OVER-TIGHTEN.

FIXING EAVES TO UPSTAND

8



Cordless
Screwdriver



Eaves Screws



T40 Security
PZ2 Bit

Align eaves to upstand as shown

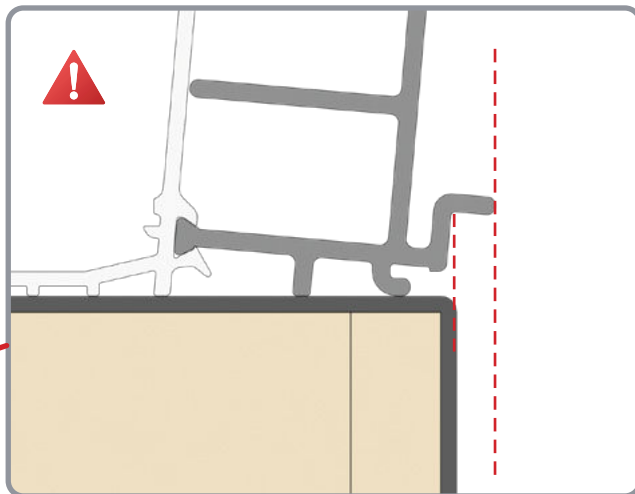
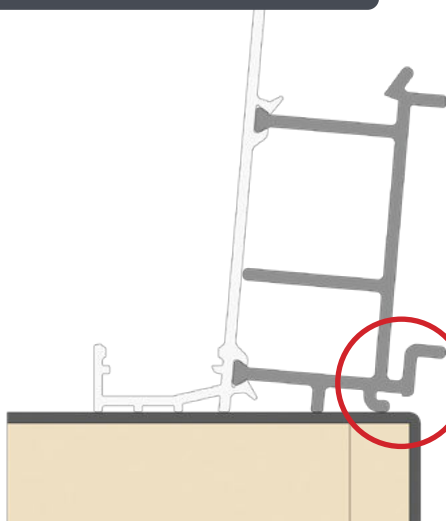

Fix lantern to the upstand using screws provided

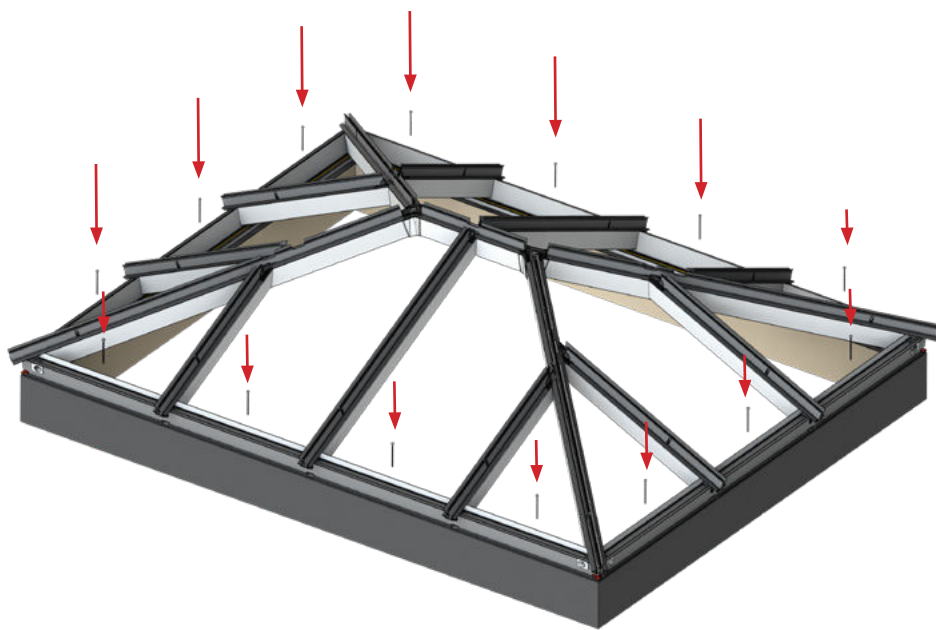

CHECK EDGE ALIGNMENT and squareness all the way along eaves before fixing.

SCREW PORT COVER / **OPTIONAL:** LED FINAL & DIFFUSER INSTALL

9

LED Diffuser /
Screw Port Cover

Do not position LED into screw channel

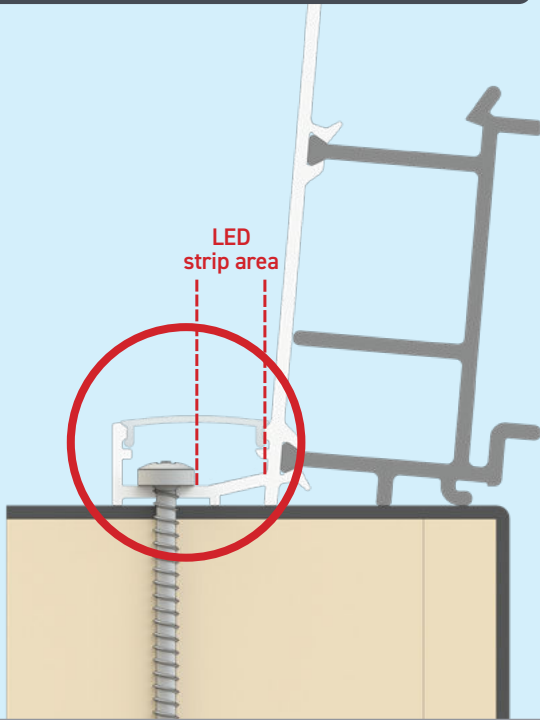

Peel off tape and stick down



Feed diffuser under rafters

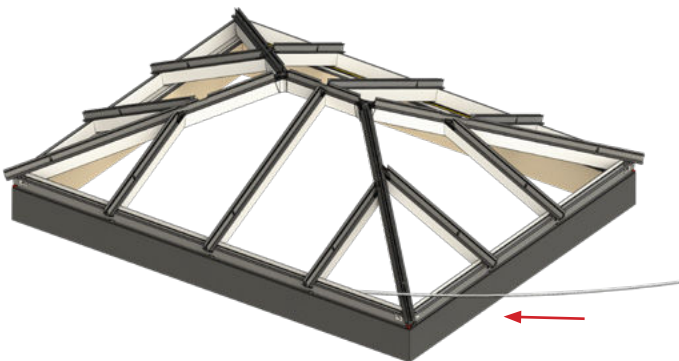

Position and click in place

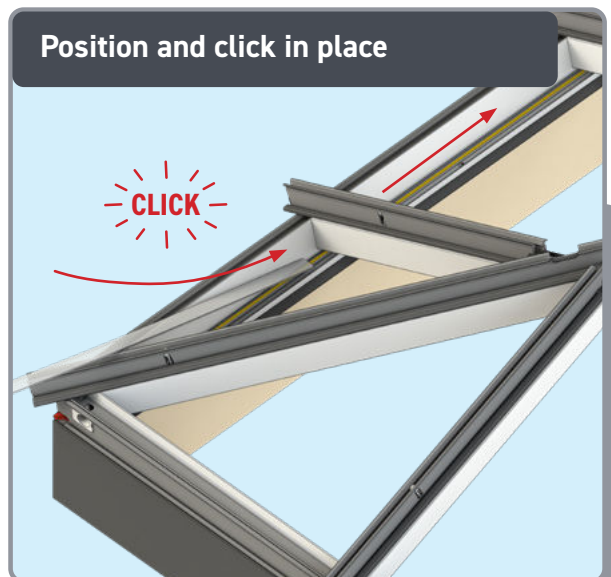

Check LEDs are working before removing backing tape.

SEALING LANTERN TO UPSTAND

10

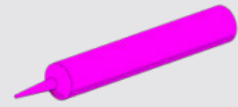

Low Modulus
Silicone Sealant

Apply sealant only where shown

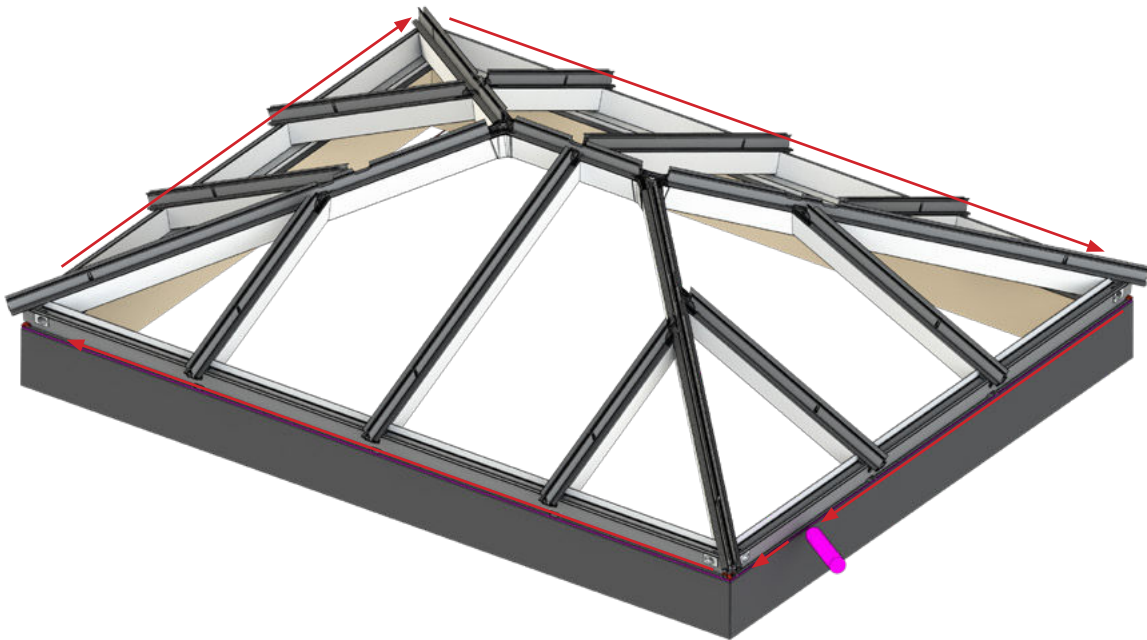
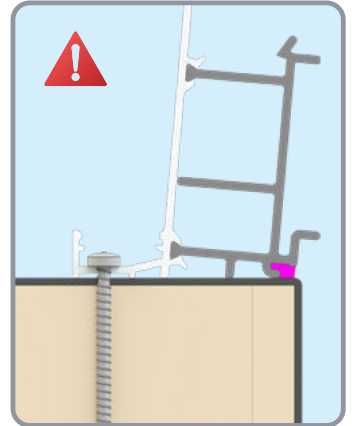
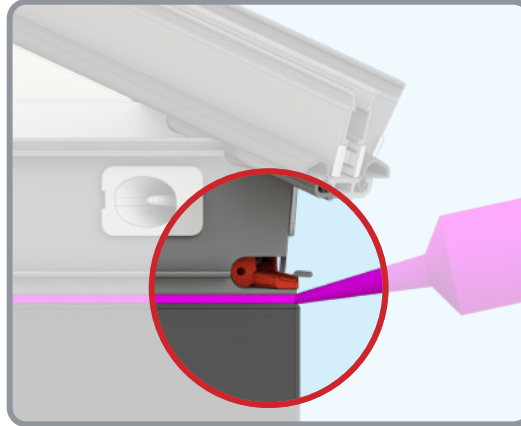

Seal until it exits adjacent hole

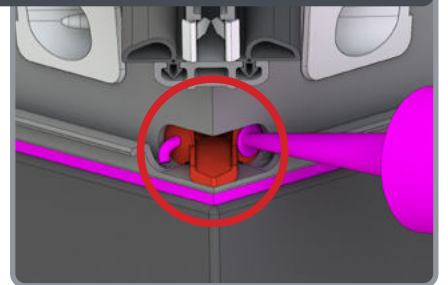
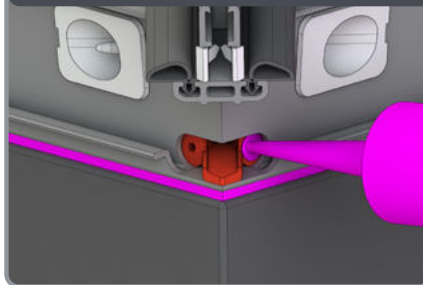

Ensure no excess sealant - could block drainage.

GLAZING

11

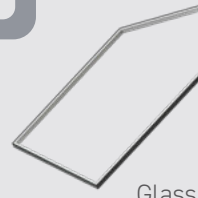

Glass



Glazing Retainers

Orientate and engage glass into glazing retainer



NOTE: Glass label is typically stuck to the interior face of glass

Centralise retainer on glass

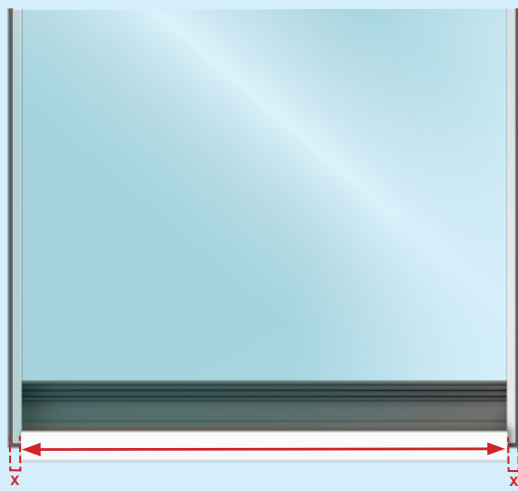

$x = \text{equal}$

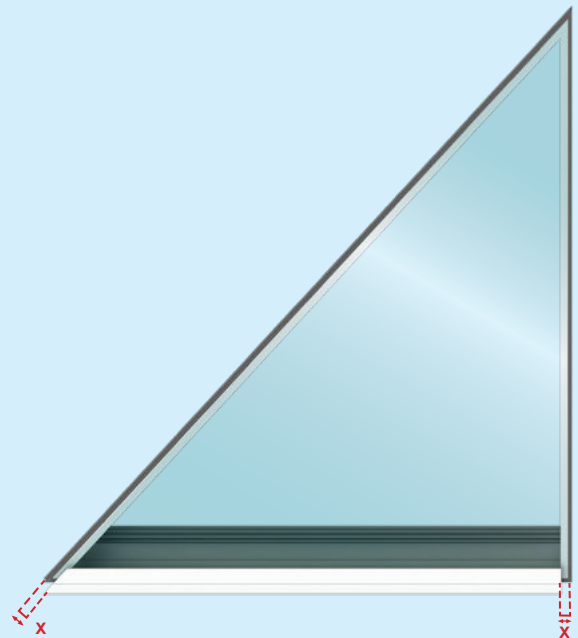

Remove all glass packaging pads and excess sealant & debris.

Locate top edge and rotate into place

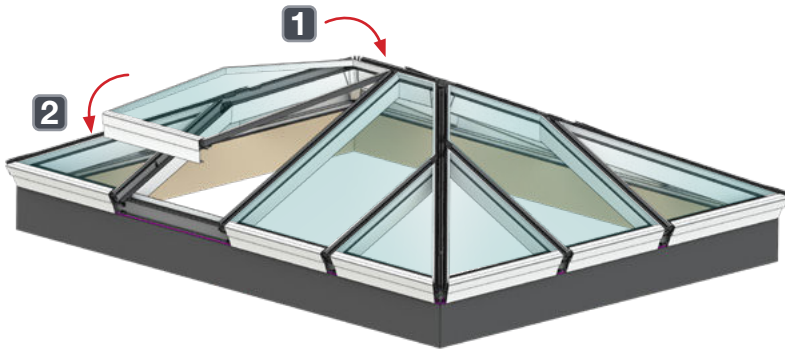

Lift & lower glass unit 100mm to engage glass lock

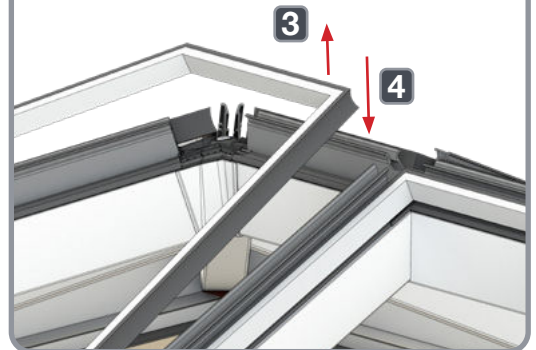

Glazing retainer engages into eaves beam

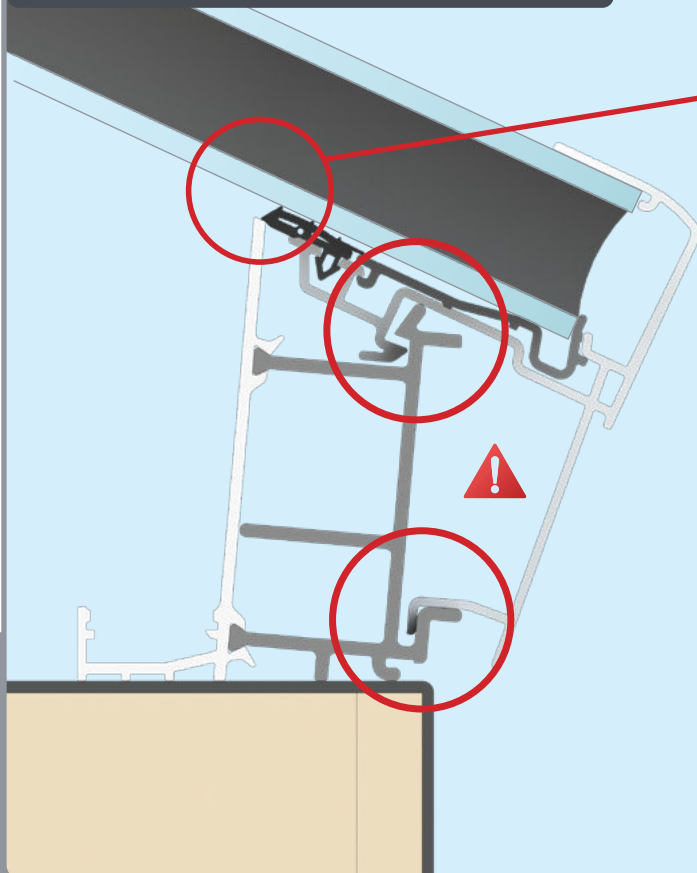

Painted profile visible through glass when engaged correctly

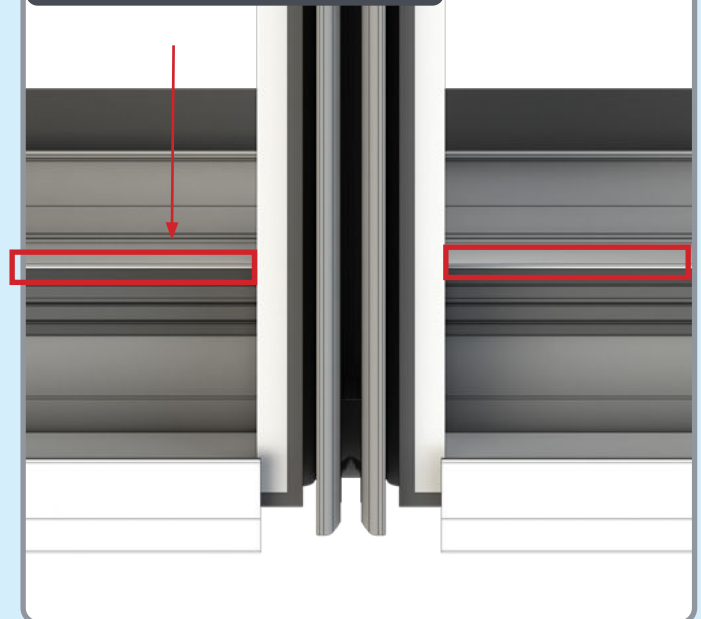

Ensure retainer is fully seated.

FITTING HIP TOP CAPS

12



Align bottom with cross bar - clip into place

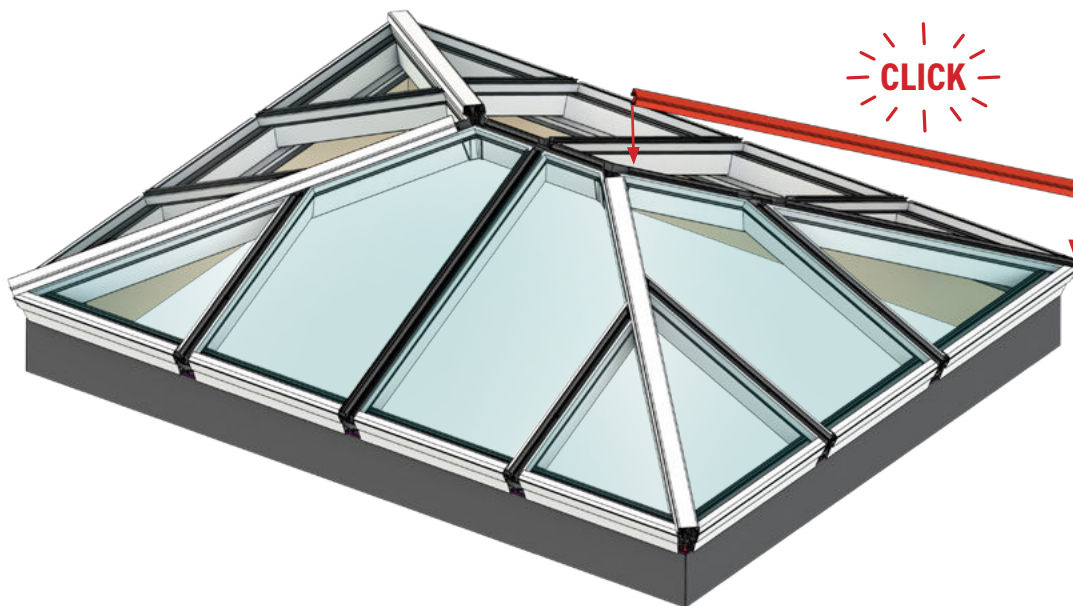

Align security inserts with notch

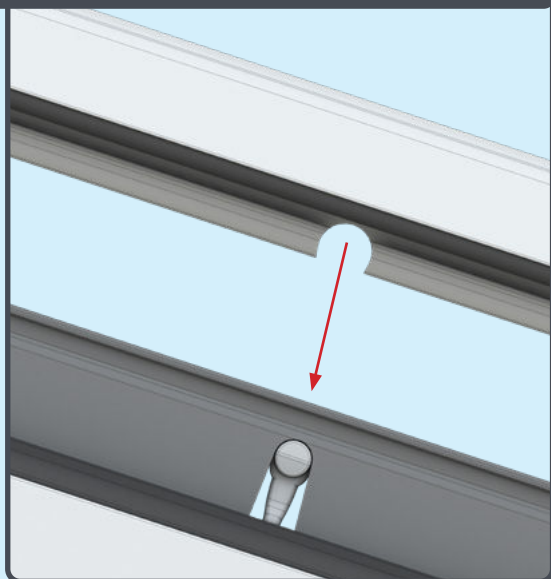

Ensure top cap aligns with end of cross bar

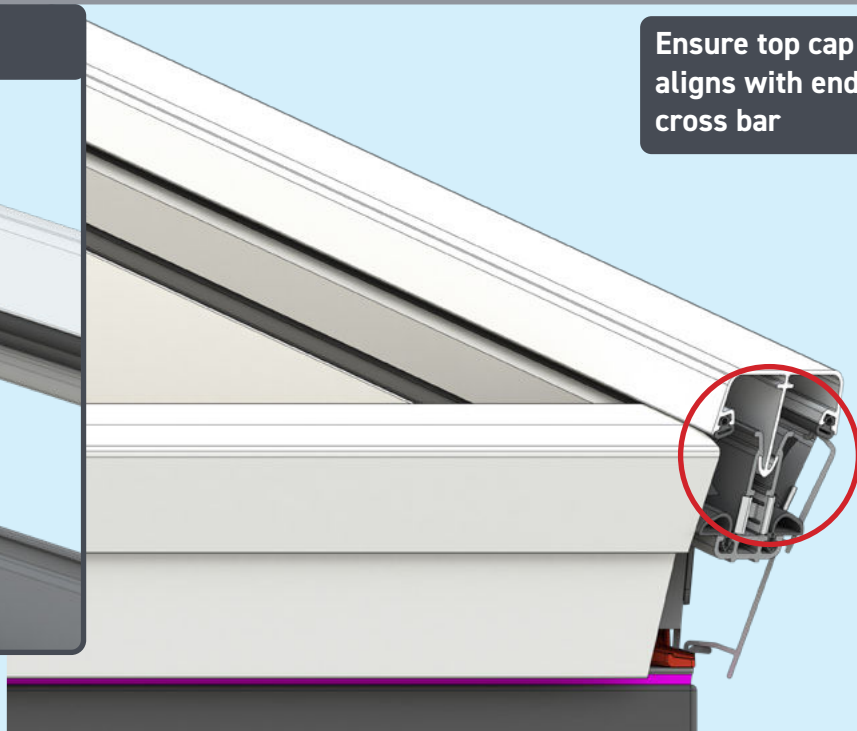

FITTING RIDGE TOP CAP

13



Ridge Top Cap

Centralise - click into place

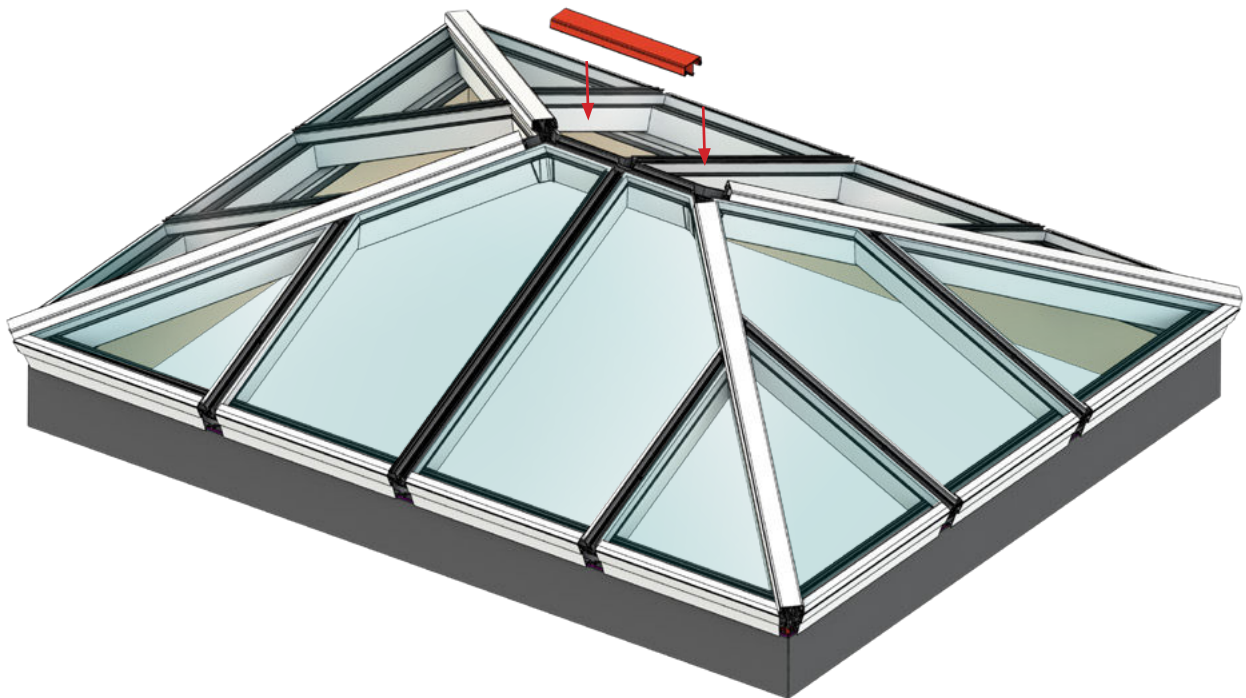
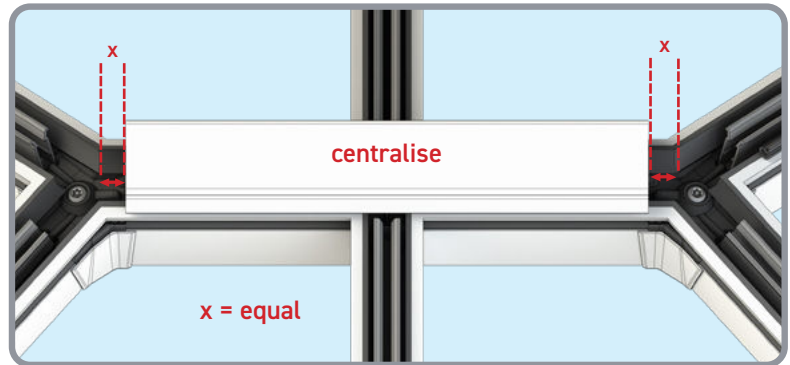

OPTIONAL - RAFTER/JACK RAFTER TOP CAPS

14



Soft mallet



Rafter Top Caps



Jack Rafter Top Caps

(1) Locate top cap into position (2) clip into place

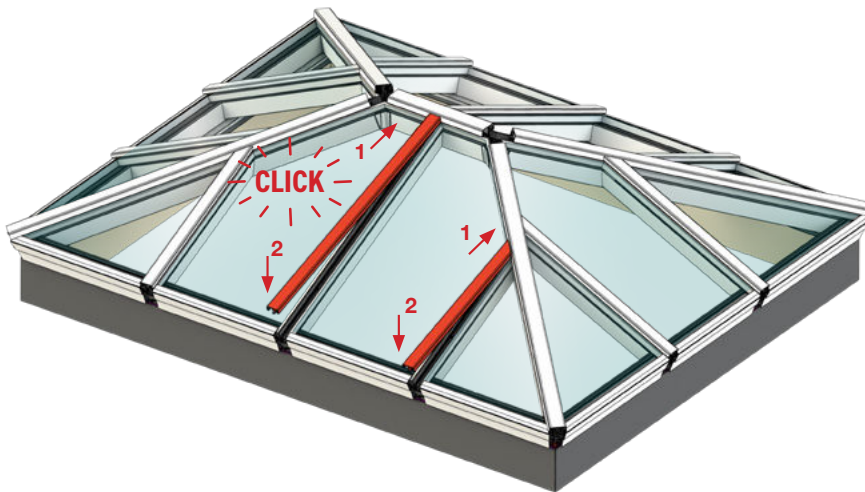

Tuck rafter under ridge seal

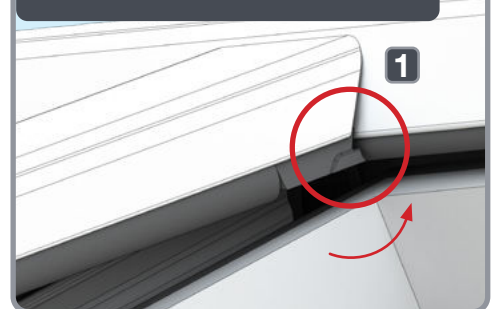

Align security inserts

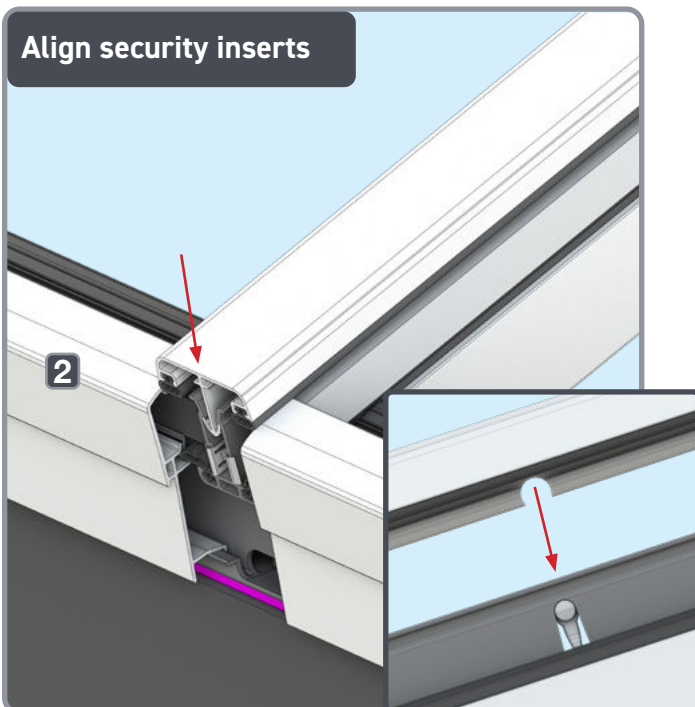

Push up into place



Tap to close with soft mallet.

FITTING BOSS TOP CAPS

15



3-Way Boss Top Caps

Press firmly to click into place

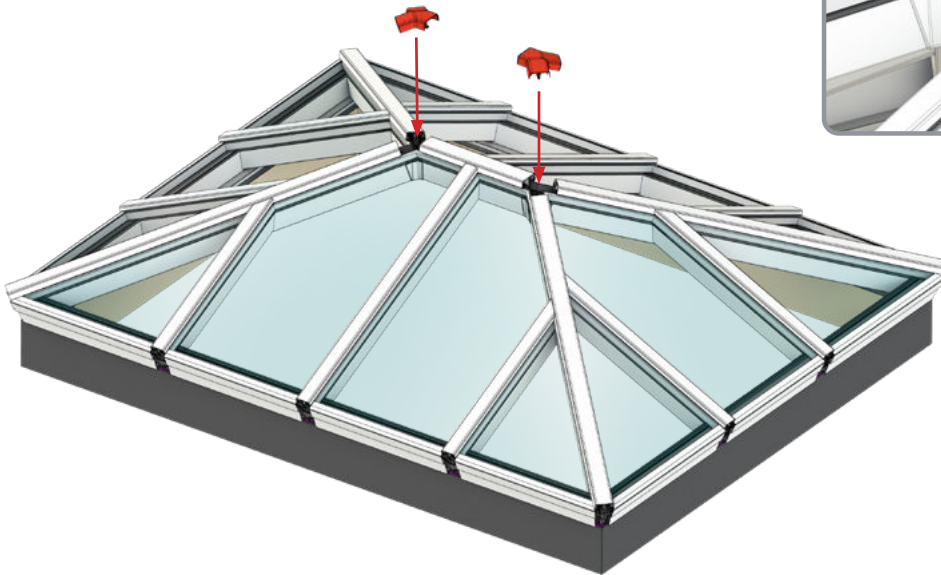

Press firmly

CLICK



Ensure all gaps closed.

FITTING HIP END CAPS

16



Hip End Caps



Rafter End Caps

Locate top edge of end cap with hip top cap before rotating into place

1

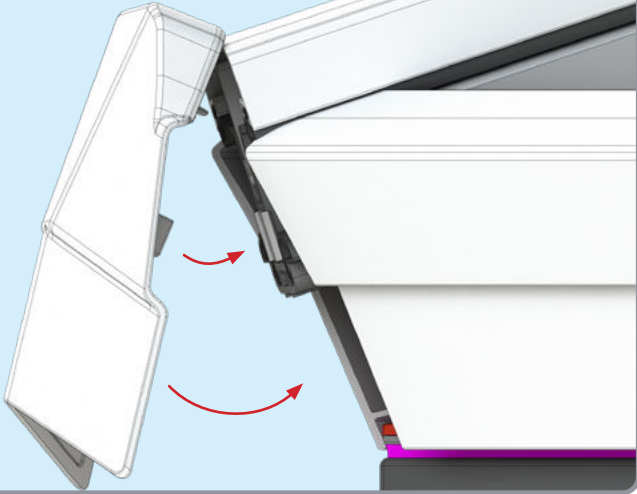

2



OPTIONAL - RAFTER END CAPS

Ensure end cap lug locates correctly

1

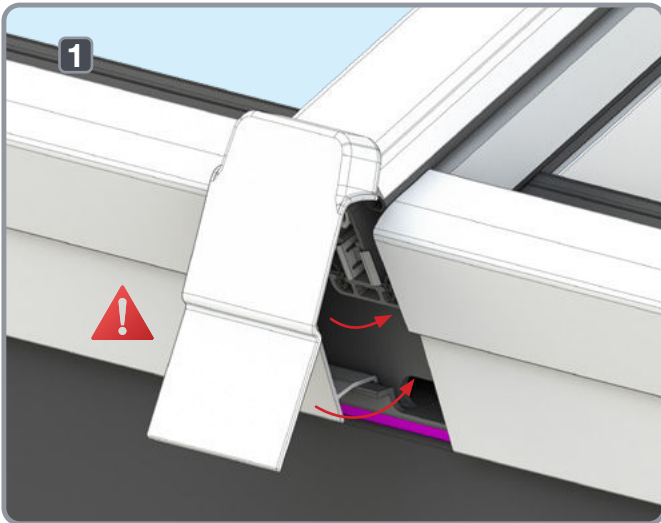

2

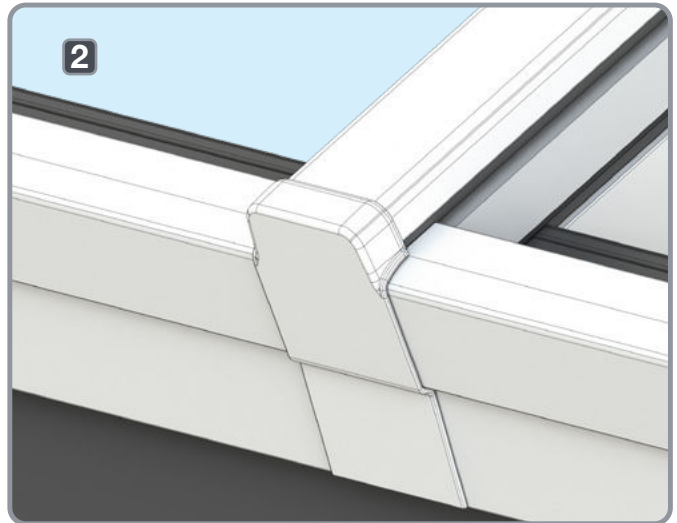

Check alignment before pushing into place.

COMPONENTS LIST

Not to Scale



3-Way Boss
A-05964



4-Way Boss
A-05965



3-Way Boss Top Cap
A-06811



4-Way Boss Top Cap
A-06814



Hip End Cap
A-05899



Rafter End Cap
A-05900



Glazing Retainer

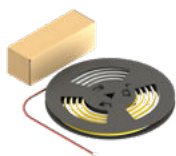

LED Kit
5m: **A-06578**
10m: **A-06579**



Eaves Screw Cover



De-glazing Tool
A-05977

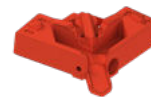

Eaves Corner Key
A-06762



Eaves Corner
Cups A
A-05896



Eaves Corner
Cups B
A-05897



Spring Clip
A-05817



Security insert
A-05976



Eaves Screw
A-05895



Eaves
Corner Screw
A-05894



Rafter Bolt
A-05957



Hip Adjuster
A-05905



Rafter Clamping Block
A-05898



Jack Rafter End Seal A
A-06729

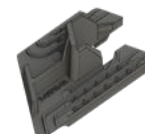

Jack Rafter End Seal B
A-06730



Ridge Rafter
End Seal
A-06731



Jack Rafter Upper
End Seal RH
A-07493



Jack Rafter Upper
End Seal LH
A-07494



Ridge Rafter Upper
End Seal
A-07538

PROFILES

Not to Scale

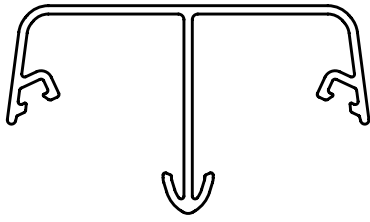

Ridge Top Cap
A-05651

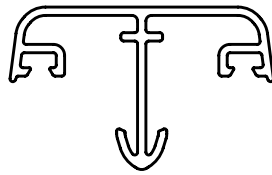

Rafter Top Cap
A-05650

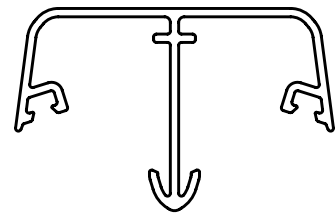

Hip Top Cap
A-05649

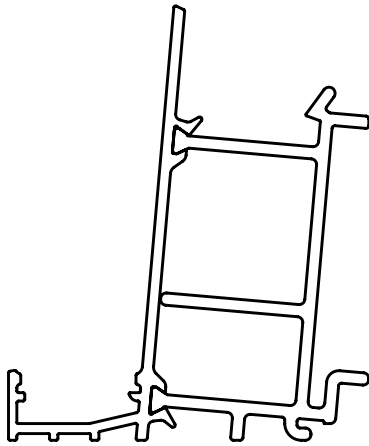

Eaves Beam
A-05653

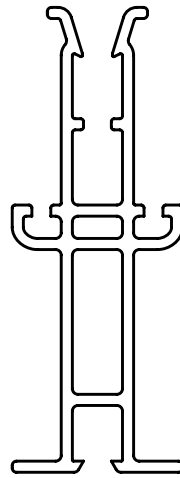

Thermal Cross Bar
A-05823

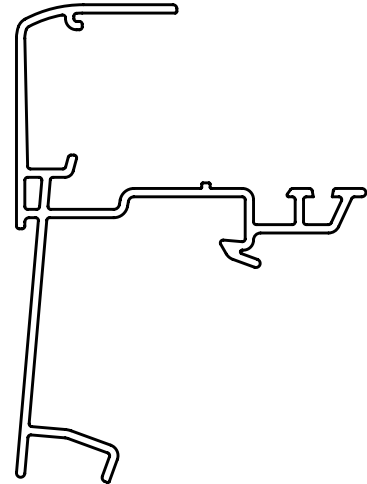

Glazing Retainer
A-05648

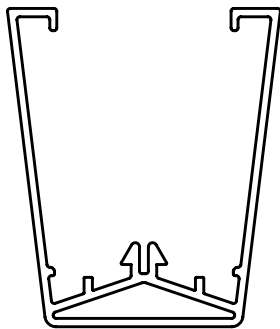

Rafter U-Channel
A-05655

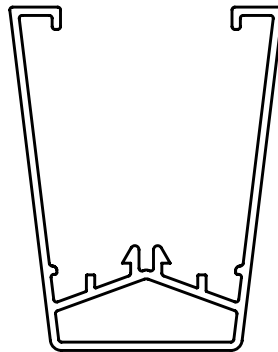

Hip and Ridge U-Channel
A-05654

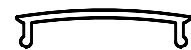

Eaves Screw Cover
A-05815



Glazing Retainer Isolator
A-05867



016 Glazing Retainer Seal
A-08359



016 Glazing Seal Upper (Hip/Rafter/Jack Rafter)
A-05806



016 Upper Glazing Seal (Ridge)
A-08358



016 Rafter Lower Seal
A-08271



016 Glazing Seal Lower (Hip/Ridge)
A-05803



www.korniche.co.uk