

Vented or Unvented direct fix on existing upstand

For Standard Flat Glass Rooflight on a 150 mm or 300mm Kerb See Page 2 overleaf



Warning!

Flat glass units are heavy.
Some units may require a mechanical lift

Contents

i Please unpack and check that all correct parts are included and undamaged.

Standard Flat Glass Rooflight (Unvented or Vented)

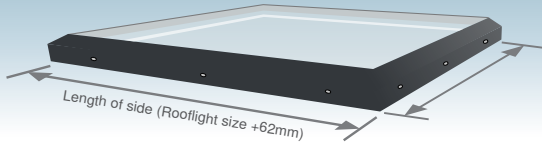

Plus, for Ventilated Version Only

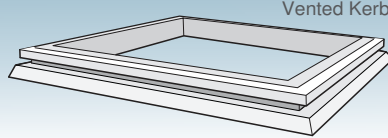

With this assembly, you will receive:
Glass Unit Fixings

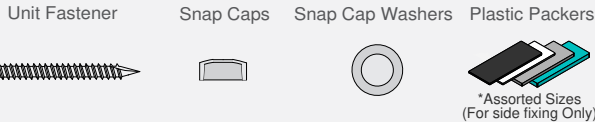

For Unvented assembly:



For vented assembly, you will receive:

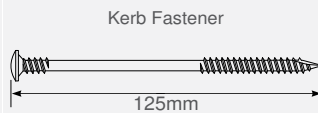

Fixing Quantities - Kerb

Length of Nominal Unit Side (mm)	Number of fixings per side
600, 750	2
900, 1050, 1200	3
1350, 1500, 1650	4
1800, 1950	5
2100, 2250	6
2400	7

(All fixings supplied in packs of 5.)

Fixing Quantities - Glass Unit

Length of Nominal Unit Side (mm)	Number of fixings per side
< 900	2
> 901, < 1500	3
> 1501, < 2000	5
> 2001	7

(fixings supplied in packs of 4.)

Installation

i Please note that all Health and Safety Regulations must be followed on site throughout the installation process.

Standard Flat Glass Rooflight Unvented on to existing upstand

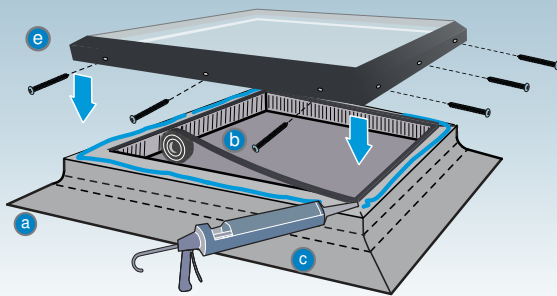

Standard Flat Glass Rooflight Vented onto existing upstand

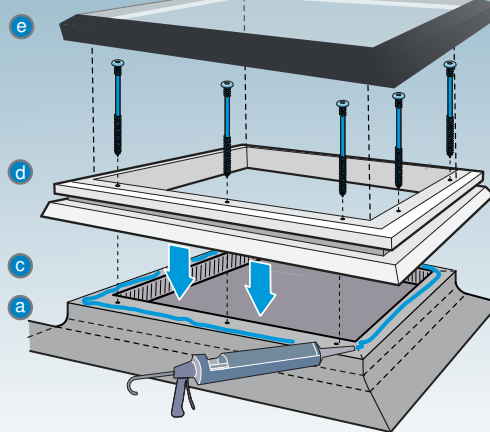

Fixing to Upstand

NOTE: Upstand external dimensions for this unit are: Nominal Rooflight size +20mm/-0mm

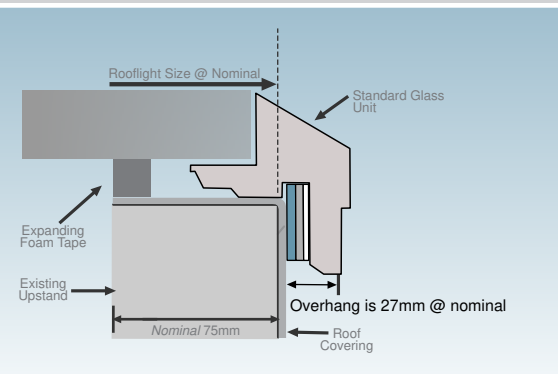

Vented Kerb Fixing

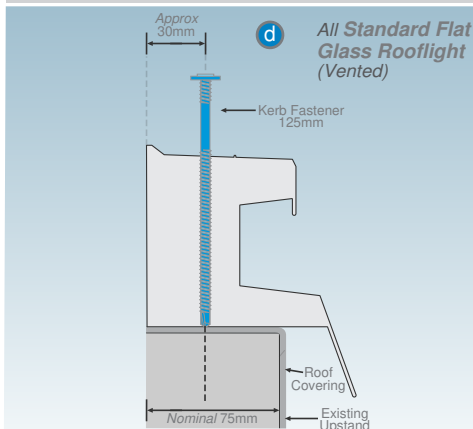

Fixing to Vented Kerb

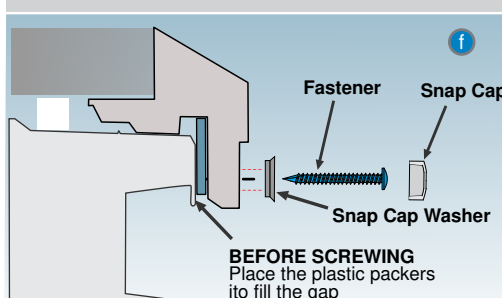

Installation Instructions

a Install roof covering to cover existing upstand in accordance with manufacturer's installation recommendations.

N.B. It is important that there should be no excessive build up of layers, the top surface should be level and free from any protrusions or projections which may prevent adequate weather proofing.

***For Ventilated Version go to c**

b For Non Ventilated Version: Apply expanding foam tape around the inside edge of the upstand opening.

c Mastic/Silicone around the outside edge of the upstand.

***For Non Ventilated Version go to e**

d For Ventilated Version: Correctly place vented kerb, ensuring it is located squarely to the upstand. Fix vented kerb to the existing upstand using the 125mm vented kerb fastener.

e Correctly place glass unit squarely on top of the completed upstand/secured vented kerb ensuring even gap on all sides.

f Fix the glass unit to the vented kerb or existing upstand.

Use the supplied unit fasteners through the nylon washer

BEFORE SCREWING in the fastener, place the plastic packers to fill the gap between the frame and the upstand/vented kerb.

AFTER SCREWING fit snap caps over the head of each fastener.

TECHNICAL SUPPORT: For any technical information/queries please contact your supplier.

The manufacturer operates a policy of continuous product improvement, and reserves the right to alter specifications at any time without notice. Every effort has been taken to ensure all details contained in this document are correct at the time of going to press but this document should be used only as a guide and does not in any way form part of a contract or warranty. It is the customer's responsibility to ensure that the product is suitable for the actual conditions of use, which are beyond the control of the manufacturer.



Warning!

Flat glass units are heavy.
Some units may require a mechanical lift

Contents

i Please unpack and check that all correct parts are included and undamaged.

Standard Flat Glass Rooflight

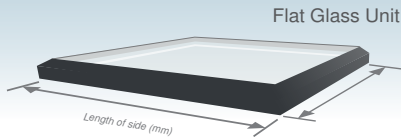

All Standard Flat Glass Rooflight

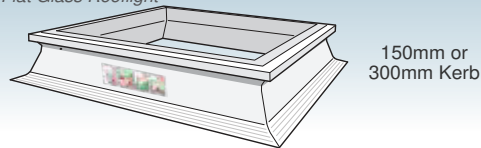

With this assembly, you will receive:

Glass Unit Fixings

Unit Fastener

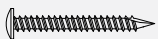

Snap Caps



Snap Cap Washers



Plastic Packers

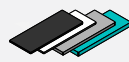

*Assorted Sizes (For side fixing Only)

Kerb Fixings

Kerb Fastener

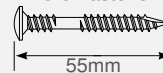

Fixing Quantities - Kerb

Length of Nominal Unit Side (mm)	Number of fixings per side
600, 750	2
900, 1050, 1200	3
1350, 1500, 1650	4
1800	5
2400	7

(Fixings supplied in packs of 5.)

⚠ Please note that all Health and Safety Regulations must be followed on site throughout the installation process.

Installation

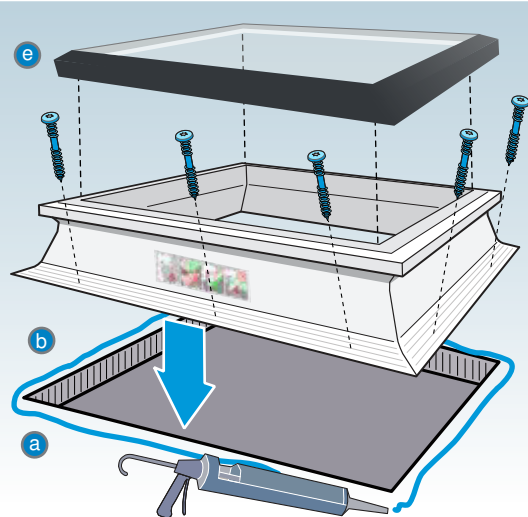

⚠ Please note that all Health and Safety Regulations must be followed on site throughout the installation process.

Installation

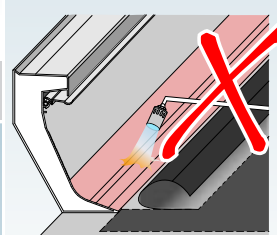
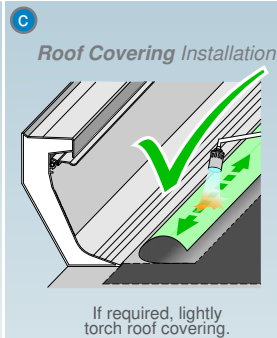

d **IMPORTANT:**
You Will Receive Either

Type A 'CLAMP'



OR
Type B 'COVER TRIM'



Fixing Quantities - Glass Unit

Length of Nominal Unit Side (mm)	Number of fixings per side
< 900	2
> 901, < 1500	3
> 1501, < 2000	5
> 2001	7

(fixings supplied in packs of 4.)

Installation Instructions

a Mastic/Silicone around the edge of the roof opening and correctly place kerb, ensuring it is located squarely over the roof opening.

b Fix kerb to the roof using the 55mm kerb fastener.

See above **Fixing Quantities - Kerb** table for the correct quantity of fasteners required for the size of the glass unit.

N.B. Length of side refers to the nominal glass unit size (equivalent to inside base of kerb foot).

c Remove and retain kerb label then install roof covering up to lip, ensuring it **does not** foul clamp or cover trim. Install in accordance with manufacturer's installation recommendations.

N.B. Never apply direct heat or naked flame to the rooflight! Ensure the roof covering **does not** foul clamp or cover trim!

d Lock the roof covering clamp or cover trim down fully, following instructions on kerb label

e Place glass unit squarely on top of the secured kerb ensuring even gap on all sides.

f Fix the glass unit to the kerb

Use the supplied unit fasteners through the nylon washer. Only screw through pre drilled holes.

BEFORE SCREWING in the fastener, place the plastic packers to fill the gap between the frame and the kerb.

AFTER SCREWING fit snap caps over the head of each fastener.

Kerb Installation

b c All Standard Flat Glass Rooflight (Unvented or Vented)

- Kerb
- Roof Covering
- Structural Member
- Insulation

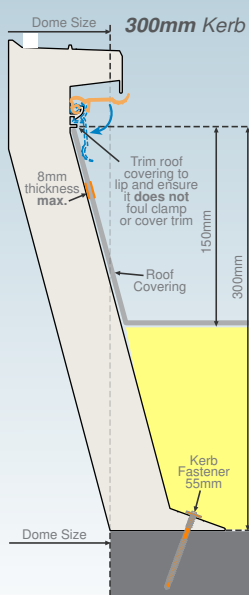
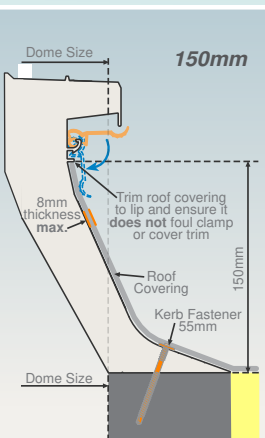

Fixing to Kerb

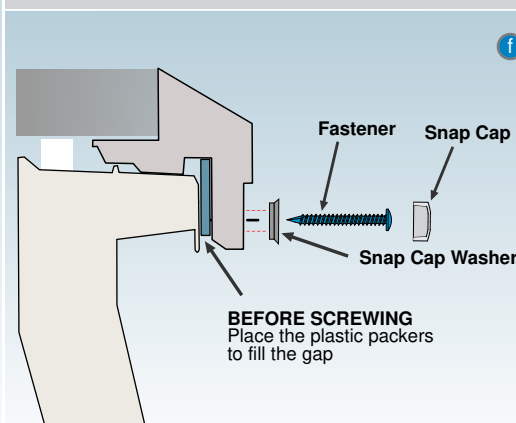

Ⓜ TECHNICAL SUPPORT: For any technical information/queries please contact your supplier.

The manufacturer operates a policy of continuous product improvement, and reserves the right to alter specifications at any time without notice. Every effort has been taken to ensure all details contained in this document are correct at the time of going to press but this document should be used only as a guide and does not in any way form part of a contract or warranty. It is the customer's responsibility to ensure that the product is suitable for the actual conditions of use, which are beyond the control of the manufacturer.